

THE 8th INTERNATIONAL CONFERENCE on ADVANCED COMMUNICATION TECHNOLOGY

Toward the Era of Ubiquitous Networks and Societies



**Phoenix Park, Korea
Feb. 20–22, 2006**

**FINAL
PROGRAM**

Host



Organizers



Sponsors





TABLE of CONTENTS

MESSAGE	2
OBJECTIVES	4
COMMITTEE	4
SESSION OVERVIEW	5
INVITED SESSION	8
TECHNICAL SESSION	9
REGISTRATION	52
VENUE	53
CONFERENCE-SITE FLOOR DETAILS	54
TRANSPORTATIONS	55
OTHER INFORMATIONS	67



MESSAGE

Message from the ICAC2006 General and Organizing Chairs

On behalf of the ICAC2006 Organization and Operation Committee, I extend our warm welcome to the professionals in the field of communications from all over the world present at this grand meeting, namely International Conference on Advanced Communication Technology 2006. The ICAC2006, the 8th of the series conference, is a series of international academic event in the communications field, which all the experts from home and abroad gather to present their work, and share new ideas and visions for achieving the future telecommunication age. I hope that you will enjoy both the excellent technical content and recreational parts of the meeting.



The communication network is in a transition toward the era of ubiquitous networks and services received increasing attention over the last two or three years. No one can deny that technology has already permeated diverse aspects of human life. Mobile phones and the Internet -- the biggest success stories our industry has ever seen -- are only the beginning. The Ubiquitous Networks and Services will make it possible to connect anytime, anywhere, by anything and anyone. In a ubiquitous network, everyone and everything can be connected, and new innovations that will completely change the current dimension of IT technology are expected. ICAC2006 will provide the present and future of the ubiquitous networks and services. It will also give the basic characteristics, applications, issues and standardization of the ubiquitous networks and services.

In closing, I would like to express my sincere appreciation for the committee members and the referees for their contributions who have been helping us to prepare the event. I also sincerely thank all the authors for the papers on their precious technical achievements. I have no doubt of successful ICAC2006, and you will enjoy both the high technical talks of the sessions and the beautiful landscapes of Phoenix Park.

Have a pleasant stay in Phoenix Park.

IEEE ICAC2006
Professor Minho Kang, General Chairman
Dr. Thomas Byeong-Nam Yoon, Organizing Chairman



MESSAGE

Message from the Technical Program Committee Chair

I would like to welcome to ICACt2006! It is a great pleasure to host this 8th ICACt2006 in Korea which is one of the countries recently drawing much attention in the world arena of high speed Internet.

ICACt is an IEEE-sponsored annual conference providing an open forum for researchers, engineers, policy makers, network planners, and service providers in telecommunications. Extensive exchange of information will be provided on newly emerging systems, standards, regulations, services, and variety of applications in the area of telecommunications.



Korea has richly benefited from deploying the high-speed Internet and Cellular networks providing various IT services all over the country. Approximately 80%, i.e. 13 millions, of Korean households use the high-speed Internet services, and 79%, i.e. 38 millions, of Korean people use the CDMA mobile phones now.

In Korea, the Ministry of Information and Communication(MIC) drew up the IT839 Strategy in February, 2004, which includes 8 Services, 3 Infrastructures, and 9 New Growth Engines. With a goal to develop a new virtuous cycle, the MIC has been introducing 8 new services for prompting investment into 3 essential networks, which will be the highways for 9 new sectors to grow fast. The MIC has recently revised the IT839 as u-IT839 Strategy in February, 2006.

8 Services are HSDPA/W-CDMA, WiBro, Broadband Convergence(IPTV), DMB/DTV, u-Home, Telematics/LBS, RFID/USN Application, and IT Services. 3 Infrastructures are Broadband convergence Network(BcN), Ubiquitous Sensor Network(USN), and Soft Infraware. 9 New Growth Engines are Mobile Communications/Telematics Devices, Broadband/Home Network Devices, Digital TV/Broadcasting Devices, Next-Generation Computing/Peripheral Devices, Intelligent Service Robot, IT System-on-Chip(SoC), RFID/USN Devices, Embedded Software, and Digital Contents/Software Solutions.

The theme of ICACt2006 is "Toward the Era of Ubiquitous Networks and Societies." ICACt 2006 consists of 77 technical sessions including 2 poster sessions and an invited session with two remarkable world experts. The TPC carefully selected a limited number of 442 papers from 27 countries to be presented in the technical sessions. We hope these technical sessions will help you obtain better insights into the latest trends and directions for the increasingly competitive future communications and Internet markets. I am sure there will be an abundance of intelligent debate and information exchange, a look at what is new in the field and technology, and lots there.

Thank you everyone who has contributed to the technical program - the authors, the reviewers, and the technical program committee members for their terrific work in collecting and editing the papers. On behalf of the Technical Program Committee, I wish you a productive and enjoyable conference.

Dr. Hyeong-Ho Lee
ICACt2006 Technical Program Committee Chairman



OBJECTIVES

ICACT will provide an open forum for researchers, engineers, policy makers, network planners, and service providers in telecommunications. Extensive change of information will be provided on newly emerging systems, standards, services and variety of applications in the area of telecommunications.



COMMITTEE

General Chair

Prof. Minho Kang, ICU, Korea

International Steering Committee

Dr. Chu-Hwan Yim, ETRI, Korea (Chair)
Dr. Kyung Pyo Jun, ETRI, Korea
Dr. Minho Kang, ICU, Korea
Dr. Biswanath Mukherjee, UC, Davis, USA
Dr. Aurel A. Lazar, Columbia Univ., USA
Dr. Yang Zemin, MPT, China
Dr. Byeong Gi Lee, SNU, Korea
Dr. Edgardo V. Cabarios, NTC, Philippines
Dr. Khairuddin Ab. Hamid, UNIMS, Malaysia
Dr. Hideyoshi Tominaga, Waseda Univ., Japan
Dr. Kwan-Ho Song, NIDA, Korea
Dr. David Al-Dabass, Nottingham Trent University, UK
Dr. Mun-Kee Choi, ICU, Korea
Mr. Masatoshi Hattori, AIC, Japan
Dr. A. Koucheryavy, NIIS, Russia
Dr. Nguyen Kim Lan, PTIT, Vietnam
Mr. Yogi Pratomo W, PT Telkom, Indonesia
Dr. Kee Chiang Chua, National Univ. of Singapore
Dr. Sudip Misra, ChartWELL, Inc., Canada

Organization Committee

Dr. Byeong-Nam Yoon, NCA, Korea (Chair)
Mr. Joon-Ho Kim, MIC, Korea
Mr. Atsushi Yano, NTT, Japan
Dr. Nelu Mihai, AT&T, USA
Dr. Mazlan Abbas, Celcom, Malaysia
Dr. Suk-Hyun Shin, B-KyunG SYSTEM, Korea
Dr. Seong-IL Jin, CNU, Korea
Dr. Kyeung-Hak Seo, KETI, Korea
Dr. Man-Seop Lee, ICU, Korea
Dr. Chi-Jung Hwang, CNU, Korea
Dr. Whan Woo Kim, CNU, Korea
Mr. P. H. Utomo, RISTI Telkom, Indonesia
Dr. Jit Biswas, KRDL, Singapore
Dr. Eui K. Koh, New Skies Satellites, Singapore
Prof. Mounir Hamdi, Hong Kong Univ. of Science and Technology, China
Mr. Sang-Chul Shin, NCA, Korea
Mr. Young-Ro Lee, NCA, Korea
Dr. Seong Keun Lee, KT, Korea
Dr. Jin-Pyo Hong, HUFS, Korea

Technical Program Committee

Dr. Hyeong-Ho Lee, ETRI, Korea (Chair)
Dr. S. Srinivasan, University of Louisville, USA
Dr. Jin Seek Choi, Hanyang University, Korea
Dr. Huijuan Cui, Tsinghua University, China
Dr. Aysegul Gencata, Istanbul Technical Univ. Turkey
Dr. Sibabrata Ray, University of Alabama, USA
Dr. Rudra Datta, North Carolina State Univ. USA
Dr. Hyun-Kook Kahng, Korea Univ., Korea
Dr. Chang-Bong Kim, Kongju National Univ., Korea
Dr. Dereck C W Pao, City Univ. of Hong Kong, China
Dr. Jun-Kyun Choi, ICU, Korea
Dr. Yong-Hee Jeon, CUD, Korea
Dr. Hwa-Sung Kim, Kwang-Woon Univ, Korea
Dr. Jeong-Ju Yoo, ETRI, Korea
Mr. Jae-young Ahn, ETRI, Korea
Dr. Moo Wan Kim, Tokyo University of Information Sciences, Japan
Dr. Jong Hyup Lee, Inje Univ., Korea
Dr. Tony T. Lee, Chinese University, China
Dr. Mohamed Moustafa Abd-El Aziz, Thebes Academy, Egypt
Dr. Hee-Cheol Lee, Huree Univ. in Mongolia
Dr. Mitch Haspel, Stochastikos Solutions, Israel
Dr. You-Sik Hong, Sangji University, Korea
Dr. Jin-Woong Cho, KETI, Korea
Dr. Dae-Young Kim, ICU, Korea
Dr. Hee-Chang Jung, NCA, Korea
Dr. Sudip Misra, IT-Architect, Canada
Mr. Jin-Dam Mok, ETRI, Korea

Local Arrangement & Registration

Mr. Myung-Won Song, NCA, Korea (Chair)
Mr. Tae-IL Kim, ETRI, Korea (Co-Chair)
Dr. Sun-Moo Kang, Neotelecom, Korea
Mr. Yoon-Seok Ko, NCA, Korea
Ms. Won-Jung Choe, NCA, Korea



SESSION OVERVIEW

February 19 (Sunday)								
15:00 ~ 18:00	Registration (2 nd Floor, Phoenix Park Hotel)							

Day 1 : February 20 (Monday)								
08:00 ~ 18:00	Registration (2 nd Floor, Phoenix Park Hotel)							
Room	Emerald	Ruby I	Ruby II	Diamond I	Topaz I	Topaz II	Topaz III	Diamond II
09:00 ~ 10:20	Session 1A CDMA & Wireless Communications (I)	Session 1B Mobile Communications (I)	Session 1C Multimedia and Internet Systems and Services (I)	Session 1D Next Generation Network Technology (I)	Session 1E Information Security Technology (I)	Session 1F RFID & USN Technologies (I)	Session 1G System and Software Engineering (I)	
10:20 ~ 10:40	Coffee Break							
10:40 ~ 12:00	Session 2A CDMA & Wireless Communications (II)	Session 2B Mobile Communications (II)	Session 2C Multimedia and Internet Systems and Services (II)	Session 2D Next Generation Network Technology (II)	Session 2E Information Security Technology (II)	Session 2F RFID & USN Technologies (II)	Session 2G System and Software Engineering (II)	
12:00 ~ 13:20	Lunch							
13:20 ~ 14:40	Session 3A CDMA & Wireless Communications (III)	Session 3B Mobile Communications (III)	Session 3C Multimedia and Internet Systems and Services (III)	Session 3D Next Generation Network Technology (III)	Session 3E Information Security Technology (III)	Session 3F RFID & USN Technologies (III)	Session 3G System and Software Engineering (III)	
14:40 ~ 15:00	Coffee Break							
15:00 ~ 16:20	Session 4A CDMA & Wireless Communications (IV)	Session 4B Mobile Communications (IV)	Session 4C Multimedia and Internet Systems and Services (IV)	Session 4D Next Generation Network Technology (IV)	Session 4E Information Security Technology (IV)	Session 4F RFID & USN Technologies (IV)	Session 4G System and Software Engineering (IV)	Session 4H Poster Session (I)
16:20 ~ 16:40	Coffee Break							
16:40 ~ 18:00	Session 5A CDMA & Wireless Communications (V)	Session 5B Mobile Communications (V)	Session 5C Multimedia and Internet Systems and Services (V)	Session 5D Next Generation Network Technology (V)	Session 5E Information Security Technology (V)	Session 5F RFID & USN Technologies (V)	Session 5G Optical Networking Technology (I)	



SESSION OVERVIEW

Day 2 : February 21 (Tuesday)								
08:00 ~ 18:00	Registration (2 nd Floor, Phoenix Park Hotel)							
Room	Emerald	Ruby I	Ruby II	Diamond I	Topaz I	Topaz II	Topaz III	Diamond II
09:00 ~ 10:20	Session 6A CDMA & Wireless Communications (VI)	Session 6B Mobile Communications (VI)	Session 6C Multimedia and Internet Systems and Services (VI)	Session 6D Broadband Satellite & HAPS	Session 6E Information Security Technology (VI)	Session 6F IT Service Technology (I)	Session 6G Optical Networking Technology (II)	
10:20 ~ 10:30	Coffee Break							
10:30 ~ 12:00	Invited Session (Phoenix Ballroom)							
12:00 ~ 13:20	Opening Ceremony and Banquet (Phoenix Ballroom)							
13:20 ~ 14:40	Session 7A CDMA & Wireless Communications (VII)	Session 7B Mobile Communications (VII)	Session 7C Multimedia and Internet Systems and Services (VII)	Session 7D Telematics Technology	Session 7E Information Security Technology (VII)	Session 7F IT Service Technology (II)	Session 7G Optical Networking Technology (III)	
14:40 ~ 15:00	Coffee Break							
15:00 ~ 16:20	Session 8A CDMA & Wireless Communications (VIII)	Session 8B Mobile Communications (VIII)	Session 8C Multimedia and Internet Systems and Services (VIII)	Session 8D Digital Home Technology (I)	Session 8E Information Security Technology (VIII)	Session 8F IT Service Technology (III)	Session 8G Digital Broadcasting Technology (I)	Session 8H Poster Session (II)
16:20 ~ 16:40	Coffee Break							
16:40 ~ 18:00	Session 9A CDMA & Wireless Communications (IX)	Session 9B Mobile Communications (IX)	Session 9C Multimedia and Internet Systems and Services (IX)	Session 9D Digital Home Technology (II)	Session 9E ASP, WAS, P2P, CDN, and XML Technologies	Session 9F IT Service Technology (IV)	Session 9G Digital Broadcasting Technology (II)	



SESSION OVERVIEW

Day 3 : February 22 (Wednesday)								
08:00 ~ 12:00	Registration (2 nd Floor, Phoenix Park Hotel)							
Room	Emerald	Ruby I	Ruby II	Diamond I	Topaz I	Topaz II	Topaz III	Diamond II
09:00 ~ 10:20	Session 10A	Session 10B	Session 10C	Session 10D	Session 10E	Session 10F		
	CDMA & Wireless Communications (X)	Mobile Communications (X)	IPv6 Technology (I)	Communication Network Topology & Planning (I)	GRID, Distributed Computing Technologies & Services (I)	Portable Internet and Internet Telephony		
10:20 ~ 10:40	Coffee Break							
10:40 ~ 12:00	Session 11A	Session 11B	Session 11C	Session 11D	Session 11E	Session 11F		
	CDMA & Wireless Communications (XI)	Network Management, Operation and Maintenance	IPv6 Technology (II)	Communication Network Topology & Planning (II)	GRID, Distributed Computing Technologies & Services (II)	E-Commerce and M-Commerce		



INVITED SESSION

Invited Session 10:30 ~ 12:00 Feb. 21 (Tue.)

Phoenix Ballroom

Chair : Dr. Hyeong-Ho Lee (ICACT2006 TPC Chair)

Keynote Speech 1: Vision of Ubiquitous Sensor Network

Speaker : Dr. Seung-Wha Yoo
(Professor, Ajou University)

The world is experiencing a major transition from an Internet society into a ubiquitous society. Ubiquitous Sensor Network (USN) is drawing a lot of attention as a method for realizing the ubiquitous society. It collects environmental information to realize a variety of functions, through a countless number of compact wireless sensor nodes that are located everywhere to form an ad hoc arrangement. USN is the enabler that allows everybody to access and share the real-time environmental information. This invited talk introduces Korea's USN concept, vision, and deployment strategies. The vision of USN has inspired several fields of research, application and deployment. USN deployment will start with the application specific trials. The increasing application specific trials would promote the development of key USN technology, killer applications and contents.



Keynote Speech 2: Ubiquitous ID Project: Building World-Wide Ubiquitous Computing Environments

Speaker : Dr. Noboru Koshizuka
(Associate Professor, The University of Tokyo,
Vice Director of YRP Ubiquitous Networking Laboratory)

In 1984, we have started a ubiquitous computing research project in Japan, TRON Project (The Real-time Operating system Nucleus). The goal of the project is to realize a computerized environment in which small computers are embedded and cooperate with each other. Recently, with the progress of hardware technologies, computers have been becoming much smaller. Even a full-fledged computer equipped with CPU, memory and communication interfaces is implemented with a small single VLSI chip. In the computing everywhere environment, these small chips are embedded into all sorts of "things." They communicate and cooperate with each other to control our living environment or to provide rich information services to us. The computer automatically recognizes the condition of the real world, and conducts various information processing and operation according to the condition. As a result, this environment will support any activities of our daily life. Since 2000, we have started a new project "Ubiquitous ID Project" for realizing the world-wide ubiquitous computing environment on the basis of the ultra-small computer technologies. In this talk, I would like to introduce the technologies and activities of Ubiquitous ID Project.





TECHNICAL SESSIONS

Day 1 : February 20 (Monday)

Session 1 09:00 ~ 10:20

Session 1A: CDMA & Wireless Communications (I)

Room Emerald

Chair: Dr. Won Mee Jang (University of Nebraska, USA)

1. Reliable Blind Channel Estimation scheme based on Cross-correlated Cyclic Prefix for OFDM System, Taejoon Kim, Iksoo Eo (ETRI, Korea)
2. A Novel Frequency Offset Estimation Scheme Using Coherence Phase Bandwidth and Threshold for OFDM Systems, Sanghun Kim, Seokho Yoon (Sungkyunkwan University, Korea), Sun Yong Kim (Konkuk University, Korea)
3. Detection Algorithm Improving Parallel Interference Cancellation for V-BLAST System over Error Propagation, Wei Zhu, Jiyu Jin, Yongwan Park (Yeungnam University, Korea)
4. A New Scheduling Algorithm and Performance with Opportunistic Beamforming, Ting-rui Pei, Zhen Peng, Jiang-lian Cao, Zhi-qiang Yao (Xiangtan University, China)
5. Pilot Embedded scheme for Time-Variant Channel Estimation in OFDM Systems, Lidong Wang, Dongmin Lim (Gyeongsang National University, Korea)

Session 1B: Mobile Communications (I)

Room Ruby I

Chair: Mr. Jae Young Ahn (ETRI, Korea)

1. Network Configuration for Mobility in Mobile IP based System, Yun-Ji Ban (ETRI, Korea), Jung-Min Joo (KARI, Korea), Wonseok Chae, Chunghwan Lee, Kwang-Hyun Shim (ETRI, Korea)
2. Data and Query Dissemination in Wireless Sensor Networks, Karthick Kandaswamy, Jyotsna Patel, M V Ramakrishna (Monash University, Australia)
3. A Study of QoS-aware MAC Protocol with Network Adaptation, Hwi-Jin Ye, Moon Kim (Graduate School of Hankuk Aviation University, Korea), Il-Young Moon (Korea University of Technology & Education, Korea), Sung-Joon Cho (Graduate School of Hankuk Aviation University, Korea)
4. A New Mobile Internet Search Engine-Based Advertising Method and Theory, Xiaoping Wang, Zhehong Tang (China Telecom, China), Hui Luo (Broadcom Corporation, USA)
5. Multi - Agent System based Efficient Healthcare Service, Byung-mo Han, Seung-Jae Song, Kyu-Min Lee (Sungkyunkwan University, Korea), Kyung-Soo Jang (Kyungin Women's College, Korea), Dong-Ryeol Shin (Sungkyunkwan University, Korea)

Session 1C: Multimedia and Internet Systems and Services (I) Chair: Dr. G.S.V.R.Krishna Rao (University of Fort Hare, South Africa)	Room Ruby II
<ol style="list-style-type: none"> 1. Threshold-based Admission Control Method for Multicast Environment, Seng Kyoun Jo, Dipnarayan Guha, Jun Kyun Choi (ICU, Korea), Seong Gon Choi (CBNU, Korea), Jae Hum Lee (ETRI, Korea) 2. A 4-stage IPR Processing Evolution Model in Computer Communication Standardization, Toshihiko Yamakami (ACCESS, Japan) 3. Optimization of Memory Management for H.264/AVC Decoder, Shin-Haeng Ji, Jung-Wook Park, Shin-Dug Kim (Yonsei University, Korea) 4. A New Progressive Image Transmission Scheme Based on Content Feature and Gaussian Model of 2D Gel Electrophoresis Images, Tzu-Shin Tsai (Chung Shan Medical University, Taiwan), Tung-Shou Chen (National Taichung Institute of Technology, Taiwan), Jeanne Chen (Hungkuang University, Taiwan), Shih-Shan Tang (National Taichung Institute of Technology, Taiwan), Ming-Chih Chou, Shuan-Yow Li (Chung Shan Medical University, Taiwan), Tian-Shing Wang (National Taichung Institute of Technology, Taiwan) 5. Optimizing System Performance for Uncompressed HD over Gigabit Ethernet: A Case Study, Jinyong Jo, Junguk Kong, Okhwan Byeon (KISTI, Korea) 	
Session 1D: Next Generation Network Technology (I) Chair: Mr. Mahmoud Saeidi (Iran Telecommunication Research Center, Iran)	Room Diamond I
<ol style="list-style-type: none"> 1. Performance Analysis of 2-1-1 Relaying Protocol in Wireless Sensor Networks, Ho Van Khuong, Hyung-Yun Kong (University of Ulsan, Korea) 2. The Public Packet-Switched Network with Guaranteed QoS Based on DiffServ Domains Hierarchy, Yevgeni Koucheryavy (Tampere University of Technology, Finland), Alexey Vasiliev, Sergei Soloviev, Andrey Koucheryavy (ZNIIS, Russian Federation) 3. Resilient Data Delivery in Delay Bounded Overlay Multicast, Dongkyun Kim, Ki-Sung Yu, Byung-Hyeon Park (KISTI, Korea), Sang-Ha Kim (Chungnam National University, Korea) 4. A "<i>Customer Satisfaction</i>" Based Migration Approach toward NGN, Mohamed Jamoussi, Majed Al Salem (Saudi Telecom Co., Saudi Arabia) 5. Universal Ethernet Networks Based on Cycle Reservation Scheduling, Seong-Soon Joo(ETRI, Korea), Young-Chul Bang (Korea Polytechnic University, Korea) 	



TECHNICAL SESSIONS

Session 1E: Information Security Technology (I) Chair: Dr. Mureed Hussain (Paris 5 University, France)	Room Topaz I
<ol style="list-style-type: none"> 1. Considations on Security Model of Home Network, Geon-Woo Kim, Do-Woo Kim, Jun-Ho Lee, Jin-Beon Hwang, Jong-Wook Han (ETRI, Korea) 2. On the Study of Service Security Model for Privacy using Global User Management Framework, Byeong-Cheol Choi, Dong-il Seo (ETRI, Korea) 3. Hardware Implementation of Fast Division Algorithm for GF(2^m), Min-Sup Kang, Kwang-Ho Lee (Anyang University, Korea) 4. Fragment Packet Partial Re-assembly Method for Intrusion Detection, Bo-Heung Chung, Jae-Deok Lim, Seung-Ho Ryu, Young-Ho Kim, Ki-Young Kim (ETRI, Korea) 5. A Revised LKK Proxy Blind Signature Scheme, Jong-Ho Ryu, Kook-Han Kim, Dong-Il Seo (ETRI, Korea) 	
Session 1F: RFID & USN Technologies (I) Chair: Dr. Canfeng Chen (Nokia Research Center, China)	Room Topaz II
<ol style="list-style-type: none"> 1. Node-link-failure Resilient Routing Architecture for Sensor Grids, Ali Hammad Akbar, Waleed Mansoor, Shafique Ahmad Chaudhry, Ali Kashif, Ki-Hyung Kim (Ajou University, Korea) 2. Context-Aware Services Platform Supporting Mobile Agents For Ubiquitous Home Network, JungRae Kim, JaeDoo Huh (ETRI, Korea) 3. A Cluster Based Query Protocol for Wireless Sensor Networks, Zhanyang Zhang (City University of New York, USA), Guping Zheng (North China Electric Power University, China) 4. The Gateway Implementation of Sensor Network using the ARM Chip, Dal-Hwan Yoon, Ye Heon Jung, Hak Jong Ryoo, Hyung Mook Kim (Semyung University, Korea), Sung Young Choei (FielTech. Co.Ltd., Korea) 5. Performance Test Tool for RFID Middleware : Parameters, Design, Implementation, and Features, Jongyoung Lee, Naesoo Kim (ETRI, Korea) 	



TECHNICAL SESSIONS

Session 1G: System and Software Engineering (I) Chair: Dr. Myung Ki Shin (ETRI, Korea)	Room Topaz III
<ol style="list-style-type: none"> 1. Eclipse-Based Management System for Process Innovation & Methodology Enhancement, Yoonjung Choi, Su-Jung Ha, Jin-Sam Kim (ETRI, Korea) 2. A Methodological Framework for Conceptual Modeling of Optical Networks, Sudip Misra (Cornell University, USA), Subhas Misra (Super Net Solutions, Canada), Isaac Woungang (Ryerson University, Canada) 3. Implementation of Lightweight Graphic Library Builder for Embedded System, SungHo Ahn, DongMyung Sul, SeungHan Choi, KyungHee Lee (ETRI, Korea) 4. Performance Anomalies of Advanced Web Server Architectures in Realistic Environments, Takashi Shinozaki, Eiji Kawai, Suguru Yamaguchi, Heiichi Yamamoto (Nara Institute of Science and Technology, Japan) 5. Extended Role-Based Sensor Mangement Framework, Soyoung Kim, Mikyeong Moon, Keunhyuk Yeom (Pusan National University, Korea) 	
Coffee Break 10:20 ~ 10:40	

Session 2 10:40 ~ 12:00	
Session 2A: CDMA & Wireless Communications (II) Chair: Dr. Sung-Mun Shin (ETRI, Korea)	Room Emerald
<ol style="list-style-type: none">1. The Scheme to Improve the Performance of Initial Ranging Symbol Detection with Common Ranging Code for OFDMA Systems, Ki-Nam Kim, Jin-Ho Kim, Seong-Chul Kim, Sung-Joon Cho (Graduate School of Hankuk Aviation University, Korea)2. Physical Layer Analysis of Emerging IEEE 802.11n WLAN Standard, Josip Lörincz, Dinko Begušić (University of Split, Croatia)3. Adaptive Modulation and Coding on Multipath Rayleigh Fading Channels Based on Channel Prediction, Duho Rhee, Jung Hyung Kwon, Hae Kwang Hwang, Kwang Soon Kim (Yonsei University, Korea)4. SC/FDE with Constant Phase Modulation combined with CDMA and MIMO, Tufik Buzid, Steffen Reinhardt, Mario Huemer (University of Erlangen-Nuremberg, Germany), Ihan Martoyo (University of Karlsruhe, Germany)5. Low-Complexity User Selection Strategies in the Downlink of Muti-User Channels, Mingguang Xu, Dong Lin (Tsinghua University, China)	

Session 2B: Mobile Communications (II)	Room Ruby I
Chair: Dr. Chyi-Ren Dow (Feng Chia University, Taiwan)	
<ol style="list-style-type: none"> 1. On Construction of the Virtual Backbone in Wireless Mesh Networks, Deepesh Man Shrestha, Young Bae Ko (Ajou University, Korea) 2. An Internet Framework to Bring Coherence Between WAP and HTTP Ensuring Better Mobile Internet Security, Al-Mukaddim Khan Pathan, Md. Abdul Mottalib (Islamic University of Technology, Bangladesh), Minhaz Fahim Zibran (University of Lethbridge, Canada) 3. Third Party Call Control in IMS using Parlay Web Service Gateway, Jong-choul Yim, Young-il Choi, Byung-sun Lee (ETRI, Korea) 4. 1xEV-DO 3G Mobile Experimental System Project Report with a Local Market Analysis, Ren Gang (Sichuan University, China), Chen Binghai (China UNICOM, China) 5. Development of Identification System of Wire or Wireless Dispatcher based on Personal LBS, Dal Hwan Yoon, Yen Tae Jung, Dong Ju Bae, Jeong Wha Heo (Semyung University, Korea) 	
Session 2C: Multimedia and Internet Systems and Services (II)	Room Ruby II
Chair: Dr. Hee-Chang Chung (NCA, Korea)	
<ol style="list-style-type: none"> 1. Implementation Issues of a Push Event Delivery Mechanism for Web Content Service Synchronized with TV Programs, Hisao Tanaka, Eiji Kawai, Suguru Yamaguchi, Heiichi Yamamoto (Nara Institute of Science and Technology, Japan) 2. Fast 2D Both Hands Tracking with Articulate Motion Prediction, Hyejin Kim, Keun-Chang Kwak, Jaeyeon Lee (ETRI, Korea) 3. A Study on Design and Implementation of XCAP Server, Wook Hyun, Sunok Park, Iljin Lee, Shingak Kang (ETRI, Korea) 4. Blind Watermarking for Copyright Protection of 3D CAD Drawing, Ho-Kyun Park (Pusan University of Foreign Studies, Korea), Suk-Hwan Lee (TongMyung University of Information Technology, Korea), Ki-Ryong Kwon (Pusan University of Foreign Studies, Korea) 5. A Simple and Fast On-Line Evaluation System for Learning, Tung-Shou Chen, Rong-Chang Chen, Kuei-Ching Lin, Xin-Yan Wu (NTIT, Taiwan) 	

Session 2D: Next Generation Network Technology (II) Chair: Dr. Yevgeni Koucheryavy (ZNIIS, Russian Federation)	Room Diamond I
<ol style="list-style-type: none"> 1. Intelligent Network Services in Migration from PSTN toward NGN, Mahmoud Saeidi, Mahmoud Pirhadi, Fattaneh Ayazi (Iran Telecommunication Research Center, Iran) 2. Presence-based Call Reservation Service using Open API on the Web-service architecture in Broadband Converged Network, Yoo-mi Park, Young-il Choi (ETRI, Korea), Sang-ha Kim (Chungnam National University, Korea) 3. Web Services Hybrid Dynamic Composition Models for Ubiquitous Computing Networks, Dhavalkumar Thakker, Tama Osman, David Al-Dabass (Nottingham Trent University, United Kingdom) 4. Cooperative Diversity with Selection Combining in Rayleigh Fading for Wireless Ad-hoc Networks, Nam-Soo Kim, Young-Sang Kim (Cheongju University, Korea) 5. Comparative Studies of Address Lookup Algorithms for IPv6, Yiu Keung Li, Derek Pao (City University of Hong Kong, China) 	
Session 2E: Information Security Technology (II) Chair: Dr. Hyongsick Bahn (NCA, Korea)	Room Topaz I
<ol style="list-style-type: none"> 1. Security Points for BcN Infrastructure, Yang-seo Choi, Dong-il Seo, Jong-su Jang (ETRI, Korea) 2. A Lightweight IPsec Adaptation for Small Devices in IP-based Mobile Networks, Jun-Cheol Park, Ah-Hyun Jun (Hongik University, Korea) 3. A Comparative Study of Security Protocols Validation Tools: HERMES vs AVISPA, Mureed Hussain, Dominique Seret (Paris 5 University, France) 4. The Design of IPsec Application for IXDP2851, Minho Han, Kiyoun Kim, Jongsoo Jang (ETRI, Korea) 5. Defense against Lap-top Class Attacker in Wireless Sensor Network, Md. Abdul Hamid, Md. Mamun-Or-Rashid, Choong Seon Hong (Kyung Hee University, Korea) 	



TECHNICAL SESSIONS

Session 2F: RFID & USN Technologies (II) Chair: Mr. Yong-Woon Kim (ETRI, Korea)	Room Topaz II
<ol style="list-style-type: none"> 1. An Experimental Testbed for Parcel Handling with RFID Technology, Yonghoon Choi, Jong Un Won, Jong Heung Park (ETRI, Korea) 2. Collaborative Detection and Agreement Protocol for Routing Malfunctioning in Wireless Sensor Networks, Ali Kashif Bashir, Ali Hammad Akbar, Shafique Ahmad Chaudhary, Chauhdary Sajjad Hussain, Ki-Hyung Kim (Ajou University, Korea) 3. Mobile Enabled Large Scale Wireless Sensor Networks, Canfeng Chen, Jian Ma (Nokia Research Center, China) 4. An Approach about Implementation and Use of One-Stop Healthcare Service System Using RFID Technology, Sun-Jin Kim, Nae-Su Kim (ETRI, Korea) 5. A Nano Operating System for Wireless Sensor Networks, Seungmin Park, Jin Won Kim, Kee-Young Shin (ETRI, Korea), Daeyoung Kim (CNU, Korea) 	
Session 2G: System and Software Engineering (II) Chair: Prof. Jong Hyup Lee (Inje University, Korea)	Room Topaz III
<ol style="list-style-type: none"> 1. Preliminary Design for Satellite Mission Operation from Mission Request to Command Planning, In Jun Kim, Soojeon Lee, Won Chan Jung, Jaehoon Kim (ETRI, Korea) 2. An ECA Rule-based Task Programming Language for Ubiquitous Environments, Kang-Woo Lee (ETRI, Korea), Eun-Sun Cho (Chungbuk National University, Korea), Hyun Kim (ETRI, Korea) 3. The Unified Modeling Language-Based Modeling of GMPLS Networks, Sudip Misra (Cornell University, USA), Subhas Misra (Super Net Solutions, Canada), Isaac Woungang (Ryerson University, Canada) 4. Verifying Software Streaming Systems, Ki-Hyuk Nam (ETRI, Korea), Jun-Kil Park, Jin-Young Choi (Korea University, Korea), Jeong-Joon Lee (Korea Polytechnic University, Korea), Wan Choi (ETRI, Korea) 5. Supporting Intra-Site Automatic Tunnel Addressing Protocol with a Network Processor, Byung-yeob Kim, Myungki Shin, Hyoungjun Kim (ETRI, Korea) 	
Lunch 12:00 ~ 13:20	



TECHNICAL SESSIONS

Session 3 13:20 ~ 14:40	
Session 3A: CDMA & Wireless Communications (III) Chair: Prof. Chang-Bong Kim (Kongju National University, Korea)	Room Emerald
<ol style="list-style-type: none"> 1. A Novel Blind T_{rms} Estimation Method for Wireless OFDM Systems, Athanasios Doukas, Grigorios Kalivas (University of Patras, Greece) 2. Real-Valued Self-Orthogonal Finite-Length Sequences with Maximum Absolute Value Less than 2, Peng Shao, Yoshihiro Tanada (Yamaguchi University, Japan) 3. A Study on a Comprehensive Protection Ratio Calculation Applicable to Initial Planning for Frequency Coordination in the Fixed Wireless Networks, Kyoung-Whoan Suh (Kangnam University, Korea), Joohwan Lee (ETRI, Korea) 4. A Novel OFDM Frequency Offset Estimation, Bo Hong, Xin'an Wang, Gaofa Xiao (Peking University, China) 5. A Timing Synchronization of OFDMA-TDD Systems over Multipath Fading Channels, Hyundong Kim, Sangho Choe (The Catholic University of Korea, Korea) 	
Session 3B: Mobile Communications (III) Chair: Mr. Ren Gang (Sichuan University, China)	Room Ruby I
<ol style="list-style-type: none"> 1. Scenario Decomposition based Analysis of Next Generation Mobile Services, Dongchun Shin (Chung-Ang University, Korea), Jinbae Kim (Anyang Techn. College, Korea), Seungwan Ryu (Chung-Ang University, Korea), Donsung Oh (ETRI, Korea), Joowan Lee, Minhyung Kang (Chung-Ang University, Korea) 2. Experiment of IMS Core Network enabling Ubiquitous Network, Moo Wan Kim (Tokyo University of Information Sciences, Japan), Kwang Sik Kim (GlobeTech Corp., Seoul) 3. New Call Admission Control Mechanisms Considering Adaptive Modulation Control, SungKee Noh, SeungWoo Hong, YoungHa Hwang, ByongHo Yae (ETRI, Korea) 4. Design and Implementation of Anycast Protocols for Mobile Ad-hoc Networks, Chyi-Ren Dow, Pa Hsuan, Shiow-Fen Hwang (Feng Chia University, Taiwan) 5. Directional Shadow Registration Algorithm for Efficient Cluster Mobility in Mobile Ad Hoc Networks, Keun-Ho Lee, Sang-Bum Han (Korea University, Korea), Heyi-Sook Suh (Ministry of Education & Human Resources Development, Korea), Chong-Sun Hwang (Korea University, Korea) 	

Session 3C: Multimedia and Internet Systems and Services (III) Chair: Dr. Seong-Soon Joo (ETRI, Korea)	Room Ruby II
<ol style="list-style-type: none"> 1. An Integrated Web-Based System for Two-Dimensional Electrophoresis Gel Images, Tung-Shou Chen, Tian-Shing Wang, Mao-Chuan Hsiao, Chun-Wei Tsai (NTIT, Taiwan) 2. An Efficient Text Filter for Adult Web Documents, Youngsoo Kim, Taekyoung Nam (ETRI, Korea) 3. Adaptive Spam Mail Filtering Using Genetic Algorithm, Usarat Sanpakdee, Aranya Walairacht, Somsak Walairacht (King Mongkut's Institute of Technology Ladkrabung, Thailand) 4. Human Activity Description Using Motion Verbs in WordNet, Miyoung Cho, Dan Song (Chosun University, Korea), Pankoo Kim (Cheju University, Korea) 5. PCA in Wavelet Domain for Face Recognition, Wayo Puyati, Somsak Walairacht, Aranya Walairacht (King Mongkut's Institute of Technology Ladkrabang, Thailand) 	
Session 3D: Next Generation Network Technology (III) Chair: Mr. Jae Young Ahn (ETRI, Korea)	Room Diamond I
<ol style="list-style-type: none"> 1. Improving Performance of TCP Vegas for High Bandwidth-Delay Product Networks, Yi-Cheng Chan, Chia-Liang Lin (National Changhua University of Education, Taiwan), Chia-Tai Chan (National Yang-Ming University, Taiwan), Cheng-Yuan Ho (National Chiao Tung University, Taiwan) 2. NGN Architecture for IPTV Service without Effect on Conversational Services, Jeongyun Kim, Jinho Hahm, Youngsun Kim (ETRI, Korea), Junkyun Choi (ICU, Korea) 3. An Encoding Scheme for TCAM-Based Packet Classification, Derek Pao, Yiu Keung Li, Peng Zhou (City University of Hong Kong, China) 4. Smart Window-adjustment for XCP's Congestion Management, Yuan-Rung Yang (National Chiao Tung University, Taiwan), Chia-Tai Chan (National Yang-Ming University, Taiwan), Yaw-Chung Chen (National Chiao Tung University, Taiwan), Yi-Cheng Chan (National Changhua University of Education, Taiwan) 5. Efficient End-to-End QoS Mechanism Using Egress Node Resource Prediction in NGN Network, Se Youn Ban, Jun Kyun Choi, Hyong-Soon Kim (ICU, Korea) 	



TECHNICAL SESSIONS

Session 3E: Information Security Technology (III) Chair: Mr. Yong-Woon Kim (ETRI, Korea)	Room Topaz I
<ol style="list-style-type: none">1. DRM Enabled P2P Architecture, Jae-Youn Sung (UST, Korea), Jeong-Yeon Jeong, Ki-Song Yoon (ETRI, Korea)2. TAKCS: Threshold Authentication Key Configuration Scheme for Multilayer Cluster in Mobile Ad Hoc Networks, Keun-Ho Lee, Chong-Sun Hwang (Korea University, Korea)3. Extending TLS for Trust Delegation in Home Networks, Mureed Hussain, Dominique Seret (Paris 5 University, France)4. User Authentication Mechanism using Authentication Server in Home Network, Yun-kyung Lee, Hong-il Ju, Jee-hye Park, Jong-wook Han (ETRI, Korea)5. The Expansion of Key Infection Model for Dynamic Sensor Network, Young-Sik Hwang (University of Science & Technology, Korea), Seung-Wan Han, Taek-Yong Nam (ETRI, Korea)	
Session 3F: RFID & USN Technologies (III) Chair: Prof. Dal Hwan Yoon (Saemyung University, Korea)	Room Topaz II
<ol style="list-style-type: none">1. Bedside Sensor Platform Architecture for UbiSAS in Ubiquitous Sensor Network, Yoon-Sik Yoo, Jae-Doo Huh (ETRI, Korea)2. A Study on the Implementation of the IEEE1451 on a Biomedical Sensor Network for e-Health, Jaehwan Kim, Keumsang Lim, Jungil Hu, Wooshik Kim (Sejong University, Korea)3. Optimal Coverage Deployment for Wireless Sensor Networks, Yung-Tsung Hou, Tzu-Chen Lee, Bing-Chiang Jeng, Chia-Mei Chen (National Sun Yat-Sen University, Taiwan)4. A Design and Implementation of Wireless Sensor Network Routing on Nano-Qplus Platform, Heeseok Choi, Ilgon Park, Youngsam Shin, Seungmin Park (ETRI, Korea)5. Reliable Data Aggregation Protocol for Ad-hoc Sensor Network Environments, Sang-ryul Shin, Jong-il Lee, Jang-woon Baek, Dae-wha Seo (Kyungpook National University, Korea)	



TECHNICAL SESSIONS

Session 3G: System and Software Engineering (III)	Room Topaz III
Chair: Dr. Lau Bee Theng (Swinburne University of Technology Sarawak, Malaysia)	
<ol style="list-style-type: none"> 1. APROV-SL: A Specification Language of Another Program Verifier, Taeho Kim (ETRI, Korea), Oukseh Lee (Hanyang University, Korea), Chaedeok Lim (ETRI, Korea) 2. Using Tropos to Model Quality of Service for Designing Distributed Systems, Subhas C. Misra (Super Net Solutions, Canada), Sudip Misra (Cornell University, USA), Isaac Woungang (Ryerson University, Canada), Prabhat Mahanti (University of New Brunswick, Canada) 3. A Solution for Automated Auctioning of Idle Telecom Routes, J.C. Senanayake, J.A.K. Mascranghe (Informatics International Limited, Sri Lanka) 4. Test System for Device Drivers of Embedded Systems, Yu-Seung Ma, ChaeDeok Lim (ETRI, Korea) 5. Design and Development of an User Agent for Streaming Lectures – A South African Case Study, Nyaladzi Mpofu (University of Fort Hare, South Africa), Alfredo Terzoli (Rhodes University, South Africa), Hippolyte Muyungi, G.S.V.Radha Krishna Rao (University of Fort Hare, South Africa) 	
Coffee Break 14:40 ~ 15:00	

Session 4 15:00 ~ 16:20	
Session 4A: CDMA & Wireless Communications (IV) Chair: Dr. Tufik Buzid (University of Erlangen-Nuremberg, Germany)	Room Emerald
<div>1. Pulse Design in UWB Communications using Nyquist Criterion, Won Mee Jang (University of Nebraska, USA)</div> <div>2. A Self-Tuning Contention Resolution Scheme for IEEE 802.11 Wireless LAN, Jin Boo Kim, Jeong Ho Kim, Young Ah Song, Jeong Geun Kim (Kyung Hee University, Korea)</div> <div>3. Image and Its Noise Removal in Nakagami Fading Channels, Xu Huang (University of Canberra, Australia), Allan C. Madoc (University of Melbourne, Australia)</div> <div>4. Dynamic Frequency Selection in OFDMA, Yuqin Chen, SungHwan Shon, Sang-Jo Yoo, Jae Moun Kim (Inha University, Korea)</div> <div>5. Multilayer Coding Scheme Used in MBC, Rong Sun, Jingwei Liu, Xinmei Wang (Xidian University, China)</div>	



TECHNICAL SESSIONS

Session 4B: Mobile Communications (IV) Chair: Mr. Yong-Woon Kim (ETRI, Korea)	Room Ruby I
<ol style="list-style-type: none"> 1. A Dynamic State Management Algorithm for Overloaded Systems, Kyoung Seok Lee, Byung-Han Ryu (ETRI, Korea), Cheol-Hoon Lee (Chungnam National University, Korea) 2. Receiver Initiated Algorithm for Multi-Hop Ad Hoc Networks, Bui Ki Chan, Sammy Chan, Derek Pao (City University of Hong Kong, China) 3. Movement Detection Mechanism Using Differential RSSI in Mobile MPLS Network, YoungHwan Kwon (ICU, Korea), Seong Gon Choi (Chungbuk National University, Korea), Jun Kyun Choi (ICU, Korea) 4. A Proficient Path Selection for Wireless Ad Hoc Routing Protocol, A N Al-Khwildi, H S Al-Raweshdy (Brunel University, United Kingdom) 5. An Adaptive Dynamic Scheme For A Dynamic Paging Performance In Hierarchical Mobile IPv6, Sunyoung Lee, Jongwon Choe (Sookmyung Women's University, Korea) 	
Session 4C: Multimedia and Internet Systems and Services (IV) Chair: Dr. Seong-Soon Joo (ETRI, Korea)	Room Ruby II
<ol style="list-style-type: none"> 1. Authoring System for Interactive Multi-View Visual Contents, Injae Lee, Myungsuk Ki, Seyoon Jeong, Kyuheon Kim (ETRI, Korea) 2. QoSIP: A QoS Aware IP Routing Protocol for Multimedia Data, Md. Golam Shagadul Amin Talukder (Metropolitan University, Bangladesh), Al-Mukaddim Khan Pathan (Islamic University of Technology, Bangladesh) 3. Travel Ontology for Recommendation System based on Semantic Web, Chang Choi, Miyoung Cho (Chosun University, Korea), Eui-young Kang (Cheju National University, Korea), Pankoo Kim (Chosun University, Korea) 4. An Integrated Virtual Instrumentation System Using Statistical Process Control and Image Processing, Pao-Iang Chen, Chung-Wei Huang, Tung-Shou Chen (National Taichung Institute of Technology, Taiwan) 5. Ontology-Based Context-Aware Service Engine for U-Healthcare, Eun-Jung Ko, Hyung-Jik Lee, Jeon-Woo Lee (ETRI, Korea) 	



TECHNICAL SESSIONS

Session 4D: Next Generation Network Technology (IV) Chair: Dr. Jongtae Song (ETRI, Korea)	Room Diamond I
<ol style="list-style-type: none"> 1. Design and Implementation of Recursive DNS Server, Tony Bonanno, HyoungJun Kim, Jungsoo Park (ETRI, Korea) 2. Comparison of Handover schemes for Next Generation Networks, Jongmin Lee, Myoungju Yu, Seong-gon Choi (Chungbuk National University, Korea), Eunah Kim, Junghoon Lee (ETRI, Korea) 3. QoS in I-MPLS-based Heterogeneous Networks, René Böringer, Andreas Mitschele-Thiel (Technische Universität Ilmenau, Germany), Gunnar Scharfe (IDEO Laboratories GmbH, Germany) 4. DiffProbe: One way Delay Measurement for Asynchronous Network and Control Mechanism in BcN Architecture, Jongtae Song, Soon Seok Lee, Young Sun Kim (ETRI, Korea) 5. A Framework for Absolute End-to-End Delay Guarantee Based on ADRR Scheduler, Kyung-Min Lee, Hong-Shik Park (ICU, Korea), Soon-Seok Lee, Jae-Young Ahn (ETRI, Korea) 	
Session 4E: Information Security Technology (IV) Chair: Dr. G.S.V.R.Krishna Rao (University of Fort Hare, South Africa)	Room Topaz I
<ol style="list-style-type: none"> 1. Implementation of VPN Router Hardware Platform using Network Processor, Sang-Woo Lee, Yong-Sung Jeon, Ki-Young Kim, Jong-Soo Jang (ETRI, Korea) 2. Signature Systems on Smart Card with Keys Generated by Fingerprint, Lin You (Beijing University of Aeronautics and Astronautics, China), Maozhi Xu (Peking University, China), Qibin Hou (Beijing University of Aeronautics and Astronautics, China) 3. High-Speed Attack Mitigation Engine by Packet Filtering and Rate-limiting using FPGA, Sang-Kil Park, Jin-Tae Oh, Jong-Soo Jang (ETRI, Korea) 4. IPSec Overhead Analysis in Dual Stack IPv4/IPv6 Transition Mechanisms, M. Mujinga , Hippolyte Muyingi, G.S.V.R.Krishna Rao (University of Fort Hare, South Africa) 5. Study on the Design of MDS-M2 Twofish Cryptographic Algorithm adapted to Wireless Communication, Pil-Joong Kang, Seon-Keun Lee, Hwan-Yong Kim (Wonkwang University, Korea) 	



TECHNICAL SESSIONS

Session 4F: RFID & USN Technologies (IV) Chair: Dr. Yung-Tsung Hou (National Sun Yat-Sen University, Taiwan)	Room Topaz II
<ol style="list-style-type: none"> 1. REMS and RBPTS: ALE-compliant RFID Middleware Software Platform, Taesu Cheong, Youngil Kim, Yongjoon Lee (ETRI, Korea) 2. Smartening the Environment using Wireless Sensor Networks in a Developing Country, Al-Sakib Khan Pathan, Choong Seon Hong (Kyung Hee University, Korea), Hyung-Woo Lee (Hanshin University, Korea) 3. Self-Encoded TH-PPM UWB System with Iterative Detection, Youn Seok Kim, Won Mee Jang, Lim Nguyen (University of Nebraska, USA) 4. NanoEsto Debugger: The Tiny Embedded System Debugger, In-geol Chun, Chae-deok Lim (ETRI, Korea) 5. Opportunistic Scheduling with Power Control in Ad Hoc Wireless Networks, Reizel Casaquite (Inje University, Korea), In-Yeup Kong (Pusan National University, Korea), Myung-Hyun Yoon (Korea Electronics Technology Institute, Korea), Won-Joo Hwang (Inje University, Korea) 	
Session 4G: System and Software Engineering (IV) Chair: Mr. Hsin-Kun Lai (Chang Gung University, Taiwan)	Room Topaz III
<ol style="list-style-type: none"> 1. A Dynamic Load Balancing Model For Networked Virtual Environment Systems Using an Efficient Boundary Partition Management, Jung Youl Lim, Jin Ryong Kim, Kwang Hyun Shim (ETRI, Korea) 2. Fast Soft Decision Decoding Based on Error Weights, Chang-Wei Wu, Hsin-Kun Lai, Erl-Huei Lu (Chang Gung University, Taiwan) 3. Code Generation for Linux Device Driver, Yong Hoon Choi, Woo Il Kwon, Heung Nam Kim (ETRI, Korea) 4. Single Measure Similarity for Spatial Data Management System, Lau Bee Theng, Wang Yin Chai (Swinburne University of Technology Sarawak, Malaysia) 5. Data Fusion Applied on Autonomous Ground Vehicles, Emanuel Taropa, Vason P. Srimi, Won-Jong Lee, Tack-Don Han (Yonsei University, Korea) 	

Session 4H: Poster Session (I)

Room Diamond II

1. Skimmer-shaped Linear Polarized Circular Microstrip Antennas for Miniaturization, Mi-ra Ryu (Konkuk University, Korea), Jong-Myung Woo (Chungnam National University, Korea), Jung Hur (Konkuk University, Korea)
2. Fast Handover Scheme Based on Enhanced Access Point (EAP) for Mobile IPv6, Byungjoo Park, Haniph Latchman (University of Florida, USA)
3. Embedded and Scalable Image Coding Based on Virtual SPIHT, Chen Hongxin, Liu Zhengguang (Tianjin University, China)
4. A Study of Performance Improvement on the End-host through Diagnosis of System Metrics, Kook-han Kim, Jong-ho Ryu, Dong-il Seo (ETRI, Korea)
5. New Protocol Design for Wireless Networks Security, Gamal Selim (Arab Academy for Science & Technology, Egypt), Hesham M. El Badawy (National Telecommunication Institute, Egypt), Mohamed Abdul Salam (Arab Academy for Science & Technology, Egypt)
6. Redundant Multiprocessor Interconnects for the High Capacitor Router Built on ATCA, Bup-Joong Kim, Woo-Young Choi, Hak-Suh Kim, Byungjun Ahn (ETRI, Korea)
7. Subspace Separator and Functional Link Neural Network Based Receiver for DS-CDMA Signal, Chengliang Li, Weiyu Zheng (Carleton University, Canada)
8. Design and Implementation of Linux-based Application which supports CDMA and WiBro network, Dohyung Kim, Minhong Yun, Sunja Kim (ETRI, Korea), Cheol-Hoon Lee (Chungnam National University, Korea)
9. A New Collision-free Media Access Protocol for Metro OBS Ring Networks, Sunghoon Jung, Minho Kang (ICU, Korea)
10. A Case Study using Open API on BCN: E-Business card service, Kisoon Sung, Yongil Choi (ETRI, Korea)
11. Incorporating Intrusion Detection Functionality into IXP2800 Network Processor based Router, Seungho Ryu, Bo-Heung Chung, Ki-Young Kim (ETRI, Korea)
12. Security Vulnerability and Considerations in Mobile RFID environment, Juhan Kim, Howon Kim (ETRI, Korea)
13. RS decoder architecture for UWB, Sung-Woo Choi, Sang-Sung Choi, Han-ho Lee (ETRI, Korea)
14. Improved WBAN Communication at Mental Healthcare System with the Personalized Bio Signal Devices, JY Jung, JW Lee (ETRI, Korea)
15. Dynamic Bandwidth Allocation with Minimum Long Fluctuations, Ali Reza Shams Shafigh, Forough Noroozi, Zahra Abbasi, Hamid Reza Khodabandeh (Iran Telecommunication Research Center, Iran)
16. Color Descriptor for Image Retrieval in Wavelet Domain, Ariya Utenpattanan, Orachat Chitsobhuk, Amnach Khawne (King Mongkut's Institute of Technology Ladkrabang, Thailand)
17. Virtual Route Scheme for Preventing Authentication Bypass in the WWW Environment, Seung-Hyun Kim, Seung-Hun Jin (ETRI, Korea)
18. A Remote Diagnostic Tool for USB Kernel Resources in the Embedded Linux Systems, Jeong-Si Kim, ChaeDeok Lim (ETRI, Korea)



TECHNICAL SESSIONS

Session 4H: Poster Session (I)	Room Diamond II
<p>19. A CMOS Variable Gain Amplifier with Wide Dynamic Range and Accurate dB-Linear Characteristic, Ji-Hun Kim, Chang-Seok Chae, Young-Jin Woo, Gyu-Hyeong Cho (KAIST, Korea)</p> <p>20. Basic Call Flow for Interoperability Test in the Presence Services based on SIP, MiYoung Huh, SunOk Park, Wook Hyun, JaeChon Han, IlJin Lee, ShinGak Kang (ETRI, Korea)</p> <p>21. Design of a 13.56MHz RFID System, Nak-Gwon Choi, Hyuek-Jae Lee, Sang-Hoon Lee, Seong-jeen Kim (Kyungnam University, Korea)</p> <p>22. A Load Testing Architecture for Networked Virtual Environment, Bum Hyun Lim, Jin Ryong Kim, Kwang Hyun Shim (ETRI, Korea)</p> <p>23. PN Code Acquisition Using Signed-Rank-Based Detector in Non-Gaussian Impulsive Channels, Dahae Chong, Byeongyun Lee, Sanghun Kim, Seokho Yoon (Sungkyunkwan Univeristy, Korea), Sun Yong Kim (Konkuk University, Korea)</p> <p>24. Method for Performing an Address Resdolution Protocol on EoS, Hae Sook Jeon, Tae Il Kim (ETRI, Korea)</p> <p>25. Privacy Protection based on User-defined Preferences in RFID System, Inseop Kim, Byunggil Lee, Howon Kim (ETRI, Korea)</p> <p>26. The RFID Middleware System Supporting Context-Aware Access Control Service, Jieun Song, Howon Kim (ETRI, Korea)</p> <p>27. UWB Communication and Networking Systems with Chaotic Oscillator for Low Rate WPAN, Cheolhyo Lee, Jae-Young Kim (ETRI, Korea)</p> <p>28. Performance Analysis of Satellite Payload Antenna Design Result, Jeom-Hun Lee, J-S Choi, Jae-Hoon Kim, S-P Lee (ETRI, Korea), Seung-hyeub Oh (Chungnam National University, Korea)</p> <p>29. Design of the Network Control System for OBS Satellite Communications System, Kyung Soo Choi, Jin Ho Jo, Cheon Sig Sin, Seong Pal Lee (ETRI, Korea)</p> <p>30. A Visual Feature based Video Identifying System for the TV Commercial's Monitoring, Sung Hwan Lee, Won Young Yoo, Young Suk Yoon (ETRI, Korea)</p> <p>31. Technical Standardization Status and the Advanced Strategies of the Next Generation Mobile Communications, Joo Seong Park, Hyo Jun Lee, Mintaig Kim (ETRI, Korea)</p> <p>32. Adaptive Threshold-based Link Status Update Mechanism, Tae-IL Kim, Jeong-Ju Yoo, Hae-Won Jung, Hyeong-Ho Lee (ETRI, Korea), Min Young Chung (Sungkyunkwan University, Korea), Seong-IL Jin (ChungNam National University, Korea)</p> <p>33. Optimizing Hash Table Structure of Flow Exporting Software, Woo-jin Yang, Tae-il Kim, Hae-won Jung (ETRI, Korea)</p> <p>34. Application of Control Theory in QoS Control, Dang-Hai Hoang (PTIT, Vietnam)</p>	
Coffee Break 16:20 ~ 16:40	



TECHNICAL SESSIONS

Session 5 16:40 ~ 18:00	
Session 5A: CDMA & Wireless Communications (V) Chair: Dr. Evgeny Kucheryavy (Tampere University of Technology, Finland)	Room Emerald
<ol style="list-style-type: none"> 1. The BER Performance of a Quasi-Orthogonal Minimum Output Energy Multiuser Detector for CDMA Systems in Nakagami Environment, Mohamed Moustafa Abd-El Aziz Moustafa (Thebes Academy, Egypt) 2. A Study on Bandwidth Broadening of Dual-Band Slot Antenna using Matching Patch, Tae Soon Chang, Sang Won Kang, Jong Ye Leem (Konkuk University, Korea), Baek Bong Pyo (LG Electronics, Korea) , Jung Hur (Konkuk University, Korea) 3. Propagation Characteristics of UWB Radio in a High-Rise Apartment, Simon S.M. Wong (Hong Kong SAR Government, China), Francis C.M. Lau, Chi K. Tse (Hong Kong Polytechnic University, China) 4. A Novel Cyclic-Shifted Preamble Scheme for Symbol Synchronization Based on OFDM WLANs, Xiang Zhao, Myoung-Seob Lim (Chonbuk University, Korea) 5. ROI-based Joint Source -Channel Coding for Wireless Video Transmission, Zhenming Zhang, Guangxi Zhu, Feng Wang, Lei Xie (HuaZhong University of Science & Technology, China) 	
Session 5B: Mobile Communications (V) Chair: Prof. Derek Pao (City University of Hong Kong, China)	Room Ruby I
<ol style="list-style-type: none"> 1. Performance Analysis of An Efficient QoS Scheme over IEEE 802.11e Based Wireless Access Networks, Moonsik Kang (Kangnung National University, Korea) 2. An Approach for Optimal System Selection for the ISHO in Future Convergence Network, Hung Ngoc Le, Quynh Xuan Nguyen (PTIT, Vietnam), Sung Gu Choi, Yeon Seung Shin (ETRI, Korea) 3. An Adaptive Routing Protocol Selection Algorithm Corresponding to Dynamic Wireless Network Environment, Ming-Shen Jian, Ta-Yuan Chou, Chungnan Lee (National Sun Yat-Sen University, Taiwan) 4. A Fast Handover Mechanism for IPv6 Based WiBro System, Minsik Shim, Hwasung Kim (Kwangwoon University, Korea), Sangho Lee (ETRI, Korea) 5. Considerations of Neighbor Discovery Protocol over IEEE 802.16 Networks, Joo-Chul Lee (ETRI, Korea), Youn-Hee Han (Samsung Advanced Institute of Technology, Korea), Myung-Ki Shin (ETRI, Korea), Hee-Jin Jang (Samsung Advanced Institute of Technology, Korea), Hyoung-Jun Kim (ETRI, Korea) 	

Session 5C: Multimedia and Internet Systems and Services (V) Chair: Ms. Jay Joen (NCA, Korea)	Room Ruby II
<ol style="list-style-type: none"> 1. Implementation of High Performance Objectionable Video Classification System, Hogyun Lee, Seungmin Lee, Taekyong Nam (ETRI, Korea) 2. Complexity Scalable Inter Modes Decision Algorithm for H.264 Based on Spatial Correlation, Bin Feng, Guang-xi Zhu, Wen-yu Liu (Huazhong University of Science and Technology, China) 3. Temporal Scene Management for Interactive Virtual Storytelling, Seulki Kang, Heedong Ko (Korea Institute of Science and Technology, Korea), YoonChul Choy (Yonsei University, Korea) 4. Image Registration using Hough Transform and Phase Correlation, Siwaphon Chunhavittayatera, Orachat Chitsobhuk, Kiatnarong Tongprasert (King Mongkut's Institute of Technology Ladkrabang, Thailand) 5. The Design of Digital Items Server for Processing Multi DI Clients on Ubiquitous Environments, Choon Seo Park, Jung-Keun Kim, Jin-Hwan Jeong, YongJu Lee, Ok-Gee Min, Hag-Young Kim (ETRI, Korea) 	
Session 5D: Next Generation Network Technology (V) Chair: Dr. Woojik Chun (Raonet System, Inc., Korea)	Room Diamond I
<ol style="list-style-type: none"> 1. The Role of Ethernet over SDH in QoS Switch/Router, Hong Ju Kim, Seong il Myong, Hyun Ha Hong, Jong Hyun Lee, Jung Sik Kim (ETRI, Korea) 2. Performance Comparison of Existing Mobility Management Schemes for NGN, Myoung Ju Yu, Jong Min Lee, Seong Gon Choi (Chungbuk National University, Korea), Eunah Kim, Junghoon Jee (ETRI, Korea) 3. QoS-Aware Fair Scheduling in Multihop Wireless Ad Hoc Networks, Muhammad Mahbub Alam, Md. Abdul Hamid, Choong Seon Hong (Kyung Hee University, Korea) 4. Presence Service Middleware Architecture for NGN, Sung Bo Yang (ICU, Korea), Sung Gon Choi (CBNU, Korea), Se Yun Ban (ICU, Korea), Yoo-Jung Kim (NCA, Korea), Jun Kyun Choi (ICU, Korea) 5. Design and Implementation of Adaptive Service Edge Router, Eunah Kim, Woojik Chun (Raonet Systems, Inc., Korea), Lee Yoo Kyoung (ETRI, Korea) 	



TECHNICAL SESSIONS

Session 5E: Information Security Technology (V) Chair: Dr. Lin You (Beijing University of Aeronautics and Astronautics, China)	Room Topaz I
<ol style="list-style-type: none"> 1. Design of Giga Performance VPN Router, Sang Su Lee, Sang Woo Lee, Yong Sung Jeon, Ki Young Kim (ETRI, Korea) 2. A Secure LSB Steganography System Defeating Sample Pair Analysis Based on Chaos System and Dynamic Compensation, Xiangyang Luo, Zongyun Hu, Can Yang, Shanqing Gao (Zhengzhou Information Science and Technology Institute, China) 3. Access Control for Middleware in RFID Systems, Taesung Kim, Howon Kim (ETRI, Korea) 4. Design and Development of Network Intrusion Detection System Detection Scheme on Network Processing Unit, Robin Salim, G.S.V. Radha Krishna Rao (Multimedia University, Malaysia) 5. The Design of Key Security in Ethernet PON, Jee-Sook Eun, Yool Kwon (ETRI, Korea) 	
Session 5F: RFID & USN Technologies (V) Chair: Mr. Hyoung Jun Kim (ETRI, Korea)	Room Topaz II
<ol style="list-style-type: none"> 1. Design and Implementation of Mobile RFID Technology in the CDMA Networks, Myunghee Son, Yongjoon Lee, Cheolsig Pyo (ETRI, Korea) 2. Battery Model for Wireless Networks using Photovoltaic cells, John Paul M. Torregoza, In-Yeop Kong, Won Joo Hwang (Inje University, Korea), Jong Gyu Kim (Yeung-Jin College, Korea) 3. Security in Wireless Sensor Networks: Issues and Challenges, Al-Sakib Khan Pathan (Kyung Hee University, Korea), Hyung-Woo Lee (Hanshin University, Korea), Choong Seon Hong (Kyung Hee University, Korea) 4. A Network Reference Model for B2C RFID Applications, Yong-Woon Kim, Jun-Seob Lee, Sang-Keun Yoo, Hyoung-Jun Kim (ETRI, Korea) 5. RFID Code Structure and Tag Data Structure for Mobile RFID Services in Korea, Jun Seob Lee, Hyoung Jun Kim (ETRI, Korea) 	



TECHNICAL SESSIONS

Session 5G: Optical Networking Technology (I)

Room Topaz III

Chair: Prof. Chang-Bong Kim (Kongju National University, Korea)

1. An Algorithm and a Tool for Wavelength Allocation in OMS-SP Ring Architecture, Tahir M. Riaz, Jens M. Pedersen, Ole Madsen (Aalborg University, Denmark)
2. A New DBA Scheme to Improve Bandwidth Utilization in EPONs, Dong-yeal Lee (DACOM Corp., Korea), Seung-hyeub Oh (Chungnam National University, Korea)
3. Modeling of a Step and Linear Shared Buffer using an OOP for Optical Packet Switch, Mohd Shahril Salleh, Azrin Aris, Romli Mohamad, Kaharudin Dimyati (Telekom Malaysia R&D, Malaysia)
4. An Application of a Smart Optical Amplifier to the Bidirectional Transmission, Bo-Hun Choi (Gwangju University, Korea), Chang-Bong Kim (Kongju National University, Korea)
5. Resilience of Dynamic Traffic in Mobility over WDM Optical Networks, Chen-Shie Ho (VaNung University, Taiwan)



TECHNICAL SESSIONS

Day 2 : February 21 (Tuesday)

Session 6 09:00 ~ 10:20

Session 6A: CDMA & Wireless Communications (VI)

Room Emerald

Chair: Prof. Jong Hyup Lee (Inje University, Korea)

1. Analysis of the Error Probability of a Binary Receiver in Wireless Fading Channels, Xu Huang, Dharmendra Sharma (University of Canberra, Australia)
2. Throughput Analysis of SR-ARQ Scheme with Adaptive Packet Length in Slowly Varying Rayleigh Fading Channel, Dong Yang, Wah Ching Lee (Hong Kong Polytechnic University, China)
3. Performance of Quasi-orthogonal Space-Time Block Code over Time-Selective Channel with Linear and Decision Feedback Equalizations, Youxiang Wang, Jiyu Jin, Yongwan Park (Yeungnam University, Korea)
4. Prediction of Time-Varying Multipath Fading Channel for Pre-equalization of the Signal in Uplink Mobile MC-CDMA Communications, Gagik Mkrtchyan, Katsuhiro Naito, Kazuo Mori, Hideo Kobayashi (Mie University, Japan)
5. A New Stopping Criterion for Turbo Codes, Byoung-Sup Shim, Dae-Ho Jeong, Soon-Ja Lim, Hwan-Yong Kim (Wonkwang University, Korea)

Session 6B: Mobile Communications (VI)

Room Ruby I

Chair: Dr. Yung-Mu Chen (Yuan Ze University, Taiwan)

1. An Efficient TCP Mechanism to Reduce Out-of-Sequence Packets in Mobile IPv6, Byungjoo Park, Jongdae Lee, Haniph Latchman (University of Florida, USA)
2. Study of Mobility Control Functions in Ambient Networks, Shintaro Uno (Motorola Japan, Japan), Jochen Eisl (Siemens Communications, Germany), Ramón Agüero (University of Cantabria, Spain)
3. Case Study : NoC based Next-generation WLAN Receiver Design in Transaction Level, Sung-Rok Yoon, Jin Lee, Sin-Chong Park (Information and Communications University, Korea)
4. Impact of Group Mobility on Ad hoc Networks Routing Protocols, Jim M. Ng, Yan Zhang (Nanyang Technological University, Singapore)
5. Local Authentication Mechanism for Micro Mobility in Wireless Active Network Environment, Insu Kim (Konkuk University, Korea), Keecheon Kim (Nextel Communication, USA)

Session 6C: Multimedia and Internet Systems and Services (VI) Chair: Dr. Shu-Sheng Liaw (National Tai-Chung Institute of Technology, Taiwan)	Room Ruby II
<ol style="list-style-type: none"> 1. Design and Implementation of a Storage Management Method for Content Distribution, Chang Soo Kim, Yu Hyun Bak, Sang Min Woo, Won Jae Lee, Ok Gee Min, Hag Young Kim (ETRI, Korea) 2. SDL and MSC Description of ETRI Software Streaming Protocol, Jeong-Joon Lee (Korea Polytechnic University, Korea), Ki-Hyuk Nam, Wan Choi (ETRI, Korea), Dongho Song (SOFTonNET Inc., Korea), Ki-Suk Kong (Korea Polytechnic University, Korea) 3. Designing a New Storage Technique for Face Images Transmission Using JPEG2000, Hsiu-Mei Huang, Geeng-Neng You, Fu-Song Syu (National Tai-Chung Institute of Technology, Taiwan), Shu-Sheng Liaw (China Medical University, Taiwan) 4. Design of an Adaptive Streaming System in Ubiquitous Environment, Okgee Min, Jungkun Kim, Myoungjoon Kim (ETRI, Korea) 5. The Implementaion of ISATAP Router, Sang-Do Lee, Myung-Ki Shin, Hyoung-Jun Kim (ETRI, Korea) 	
Session 6D: Broadband Satellite & HAPS Chair: Mr. Kawsu Sidibeh (Surrey University, UK)	Room Diamond I
<ol style="list-style-type: none"> 1. Enhanced Automatic Gain Control using the Hybrid Gamma Parameter in DVB-S2 System, Cheon-in Oh, Seung-hyun Choi (UST, Korea), Dae-ig Jang, Duk-kil Oh (ETRI, Korea) 2. Improvement of Burst Error Correction Using a Look-Up Table with Low Density Parity Check Coding for Compressed Ultraspectral Sounder Data, Bormin Huang, Y. Sriraja, Hung-Lung Huang (Space Science and Engineering Center, USA), Mitchell D. Goldberg (NOAA NESDIS, USA) 3. IEEE 802.11 Optimisation Techniques for Inter-Satellite Links in LEO Networks, Kawsu Sidibeh, Tanya Vladimirova (University of Surrey, United Kingdom) 4. Analysis on the Performance of the Demodulation Algorithm on the Backward Compatible Modes of DVB-S2, Seung-hyun Choi, Cheon-In Oh (UST, Korea), Tae-Hoon Kim, Deock-Gil Oh, Dae-Ig Chang (ETRI, Korea) 5. Optimum Designing of Amateur Satellite for Maximum Availability, Pejman Rezaei, Noushin Aboutorabian, Mohammad Hakkak (Tarbiat Modarres University, Iran) 	



TECHNICAL SESSIONS

Session 6E: Information Security Technology (VI) Chair: Mr. Andrey Kouchreyaby (ZNIIS, Russian Federation)	Room Topaz I
<ol style="list-style-type: none"> 1. A Method for Preventing the Leakage of the Personal Information on the Internet, Daeseon Choi, Seunghun Jin (ETRI, Korea), Hyunsoo Yoon (KAIST, Korea) 2. Detection of LTSB Steganography Based on Quartic Equation, Xiangyang Luo, Qingxian Wang, Chunfang Yang, Fenlin Liu (Information Engineering University, China) 3. Key Management Scheme for Providing the Confidentiality in Mobile Multicast, Jong-Hyuk Roh (ETRI, Korea), Kyoong-Ha Lee (Inha University, Korea) 4. Linear Cryptanalysis on Second Round Simplified AES, S. Davod. Mansoori, Hossein Khaleghi Bizaki (Malek Ashtar University, Iran) 5. Analysis of Applicability of Traditional Spam Regulations to VoIP Spam, So Young Park, Jeong Tae Kim, Shin Gak Kang (ETRI, Korea) 	
Session 6F: IT Service Technology (I) Chair: Dr. Ahsan Ullah (Hiroshima University, Japan)	Room Topaz II
<ol style="list-style-type: none"> 1. Probabilistic Approach to Model Intelligent Robot Services, Young Cheol Go, Joo-Chan Sohn, Young-Jo Cho (ETRI, Korea) 2. Collaboration Services to Support Interactions in Disaster Relief Scenarios, Sergio F. Ochoa (University of Chile, Chile), Roberto Aldunate (University of Illinois, USA) 3. CAS²: Context Awareness Service System based on Wireless Sensor Networks, Ilgon Park, Heeseok Choi, Kee-Young Shin, Jinwon Kim, Seungmin Park (ETRI, Korea) 4. Experiment of Wireless Ubiquitous Network Service using Parlay, Moo Wan Kim (Tokyo University of Information Sciences, Japan) 5. Dual Journaling Store Method for Embedded Systems, Jeong-Ki Kim, Hyung-Seok Lee, Heung-Nam Kim (ETRI, Korea) 	



TECHNICAL SESSIONS

Session 6G: Optical Networking Technology (II) Chair: Dr. Tahir Riaz (Aalborg University, Denmark)		Room Topaz III
1. Performance Analysis of the Extra Offset-Time Based QoS Mechanism in TCP over Optical Burst Switching Networks, Min-Gon Kim, Hongkyu Jeong, JungYul Choi, Ji-Hwan Kim, Minho Kang (ICU, Korea) 2. A New GMPLS Survivability Mechanism, Hua Qu, Zengzhi Li (Xi'an Jiaotong University, China), Jihong Zhao (Northwestern Polytechnical University, China) 3. Performance Evaluation of Dynamic Bandwidth Sharing-Based MAC Protocol over WDM/Ethernet-PON, Bokrae Jung (ICU, Korea), Hyunho Yun, Taeyeon Kim, Jungju Yoo (ETRI, Korea) , Minho Kang (ICU, Korea) 4. Preemptive Hybrid Scheduling Scheme for Optical Packet Switch with Class Differentiation, G. Y. II (University of Malaya, Malaysia), Mohamad Khazani Abdullah (Universiti Putra Malaysia, Malaysia), Kaharudin Dimyati (University of Malaya, Malaysia) 5. Performance Comparisons of Restoration Techniques for Fault Management in OBS Networks, YoungMin Kim, TaeHwa Kim (ICU, Korea), JungJoo Yoo, Byeong Whi Kim (ETRI, Korea) , HongShik Park (ICU, Korea)		
Coffee Break 10:20 ~ 10:30		
Invited Session 10:30 ~ 12:00 Chair: Dr. Hyeong-Ho Lee (ICACT2006 TPC Chair)		Phoenix Ballroom
1. Vision of Ubiquitous Sensor Network, Dr. Seung-Wha Yoo (Ajou University, Korea) 2. Ubiquitous ID Project: Building World-Wide Ubiquitous Computing Environments, Dr. Noboru Koshizuka (The University of Tokyo, Japan)		
Opening Ceremony and Banquet Welcome Address: Prof. Min-Ho Kang (ICACT2006 General Chair)		Phoenix Ballroom

Session 7 13:20 ~ 14:40	
Session 7A: CDMA & Wireless Communications (VII)	Room Emerald
Chair: Prof. Wah Ching Lee (Hong Kong Polytechnic University, China)	
<ol style="list-style-type: none"> 1. MIMO Partial Parallel Interference Cancellation for Space Time Block Coded MIMO-CDMA System, Sunmi Kim, Jaewon Park, Yongwan Park (Yeungnam University, Korea) 2. Performance of Adaptive Modulation in Multipath Fading Channel, Hadi K Mohammed, Rajeev Tripathi, Krishna Kant (Motilal Nehru National Institute of Technology, India) 3. Adaptive Modulation Technique with Partial CQI for Multiuser OFDMA Systems, Jung Hyoung Kwon, Duho Rhee, Il Mu Byun (Yonsei University, Korea), Younghoon Whang (IMNetpia, Korea), Kwang Soon Kim (Yonsei University, Korea) 4. The Fuzzy Control Based Multiple Threshold Channel Reservation Scheme for the Integrated UTRA FDD and UTRA TDD Mobile Radio Networks, Jeich Mar, Shu-Rong Chen, Chi-Cheng Kuo (Yuan-Ze University, Taiwan) 5. Trade-off between Performance and Complexity with various Candidates in LDPC coded MIMO-OFDM Iterative Decoding, Seongmin Noh, Sin-Chong Park (ICU, Korea) 	
Session 7B: Mobile Communications (VII)	Room Ruby I
Chair: Dr. Shintaro Uno (Motorola Japan, Japan)	
<ol style="list-style-type: none"> 1. SCTP-based Handoff based on MIH Triggers Information in Campus Networks, Yung-Mu Chen, Min-Yen Lai, Shao-Chieh Lin, Shao-Chen Chang, Tein-Yaw Chung (Yuan Ze University, Taiwan) 2. Tree-based Admission Control for Mobile QoS in DiffServ Networks, Jung-Mo Moon, Mi-Young Yun, Sang-Ho Lee (ETRI, Korea) 3. An Efficient Fast Neighbor Discovery (EFND) Scheme to Reduce Handover Latency in Mobile IPv6, Byungjoo Park (University of Florida, USA), Eunsang Whang (LG Electronics, Korea), Haniph Latchman (University of Florida, USA) 4. Performance Evaluation of WAP Packet Considering WTP SAR Algorithm and RLP in Wireless Network, Il-Young Moon (Korea University of Technology and Education, Korea) 5. A Novel Analogous Simulation Method with Applications on 3G Mobile System Planning and Optimization, Ren Gang (Sichuan University, China), Chen Binghai (China UNICOM, China) 	

Session 7C: Multimedia and Internet Systems and Services (VII) Chair: Dr. Vladimir V. Makarov (LONIIS, Russian Federation)	Room Ruby II
<ol style="list-style-type: none"> 1. Design and Implementation of SoD Engine for Linux, Ki-Hyuk Nam, Ji-Su Kim, Won-Young Kim, Jung-Min Shim, Sung-Ju Kang, Sung-Jin Heo, Wan Choi (ETRI, Korea) 2. A Novel Ad Hoc Wireless Multimedia Distribution System: Computer Simulation and System Implementation, Ren Gang (Sichuan University, China), Xie Jun (Sichuan TV Station, China) 3. Wavelet-based Scalable Video Coding with Low Complex Spatial Transform, Seongho Park, Hyungsuk Oh, Wonha Kim (Kyung Hee University, Korea) 4. A New Knowledge-Based Face Image Indexing System through the Internet, Shu-Sheng Liaw (China Medical University, Taiwan), Geeng-Neng You, Fu-Song Syu, Hsiu-Mei Huang (National Tai-Chung Institute of Technology, Taiwan) 5. A CMQ Middleware Architecture for Multimedia Application in Ubiquitous Environment, Han-Sol Park, Da-Hye Choi, You-Hyeon Jeong, Tae-Uk Choi (ETRI, Korea) 	
Session 7D: Telematics Technology Chair: Dr. Byoung Nam Lee (ETRI, Korea)	Room Diamond I
<ol style="list-style-type: none"> 1. Development of Open Telematics Service Based on Gateway and Framework, Chul-Su Kim, Jongik Kim, Woo-Yong Han, Oh-Cheon Kwon (ETRI, Korea) 2. Analysis and Implementation of Interference Analysis System for Effective Use of Radio Spectrum, Eun Cheol Kim, Jin Young Kim, Jong Heon Kim (Kwangwoon University, Korea) 3. A Nearby Server Selection Protocol based Cross-Shaped Trajectory in Sensor Networks, In Gu Han (Inha University, Korea), Yeong Hwan Tscha (Sangji University, Korea), Kyoon Ha Lee (Inha University, Korea) 4. A Novel Multipath Mitigation Scheme Based on Slope Difference of Correlator Output for Galileo Systems, Chulho Lee, Seungsoo Yoo (Konkuk University, Korea), Seokho Yoon (Sungkyunkwan University, Korea), Sun Yong Kim (Konkuk University, Korea) 5. Design and Implementation of Status based Application Manager for Telematics, Minjung Kim, Yeonjune Choi, YoungBag Moon, Sunjoong Kim, Oh-Cheon Kwon (ETRI, Korea) 	



TECHNICAL SESSIONS

Session 7E: Information Security Technology (VII) Chair: Prof. Seung-Hoon Hwang (Dongguk University, Korea)	Room Topaz I
<ol style="list-style-type: none"> 1. Identity Based KCDSA Signcryption, Jong-Ho Ryu, Youn-Seo Jeong, Dong-il Seo (ETRI, Korea) 2. Quantum Signature Scheme with Message Recovery, Jian Wang, Quan Zhang, Chao-jing Tang (National University of Defence Technology, China) 3. Investigation of Feasible Cryptographic Algorithms for Wireless Sensor Network, Kyung Jun Choi, Jong-In Song (GIST, Korea) 4. Priority-based High-speed Intelligent Rule-checking, Saraswathi Sachidananda, Mintu Shah, Srividya Gopalan, Sridhar Varadarajan (Satyam Computer Services Ltd., India) 5. Pairwise Key Establishment Mechanism based on Clustering for Secure Sensor Network, Inshil Doh, Mihui Kim, Kijoon Chae (Ewha Womans University, Korea) 	
Session 7F: IT Service Technology (II) Chair: Prof. Moo Wan Kim (Tokyo University of Information Sciences, Japan)	Room Topaz II
<ol style="list-style-type: none"> 1. Efficient offering Service Creation Experience Environment for Open Service, Seunghwa Chung, Sangki Kim (ETRI, Korea) 2. A Strategy to Share Documents in MANETs using Mobile Devices, Andrés Neyem, Sergio F. Ochoa, José A. Pino (University of Chile, Chile) 3. Design of the Automatic Ontology Building System about the Specific Domain Knowledge, Hyunjang Kong, Myunggwon Hwang, Pankoo Kim (Chosun University, Korea) 4. A Study on Surface Subdivision, Ahsan Ullah, Koichi Harada (Hiroshima University, Japan) 5. What Should We Watch Over to Adopt RFID for Pharmaceutical Supply Chain in Korea?, Inkyu Lee, Hajae Chung (ETRI, Korea) 	

Session 7G: Optical Networking Technology (III) Chair: Mr. Mohd Shahril Salleh (Telekom Malaysia R&D, Malaysia)		Room Topaz III
<ol style="list-style-type: none"> 1. On the Pacing Technique for High Speed TCP over Optical Burst Switching Networks, Moonsoo Kang, Jeonghoon Mo (ICU, Korea) 2. Application-aware Contention Resolution Scheme for Grid Services over OBS Networks, Byungsang Kim, Ji-Hwan Kim, Min-Gon Kim, Minho Kang (ICU, Korea) 3. Label swapping in All-Optical Networks Using Tunable Fiber Bragg Grating Arrays, M. Rajabvand, F. Behnia, M. T. Fatehi (Sharif University of Technology, Iran) 4. Optical Buffer-based Service Differentiation in Burst Switching-based Optical Networks, JungYul Choi, Minho Kang (ICU, Korea) 5. IP Service Schemes for Ethernet PON and an EPON Master Chip Designed to Provide Such Services, Chan Kim, Jeong-Gook Kwon, Tae-Whan Yoo, Yool Kwon, Bong-Tae Kim (ETRI, Korea) 		
Coffee Break 14:40 ~ 15:00		
Session 8 15:00 ~ 16:20		
Session 8A: CDMA & Wireless Communications (VIII) Chair: Dr. Heang Suk Oh (ETRI, Korea)		Room Emerald
<ol style="list-style-type: none"> 1. A Non-coherent UWB Ranging for Precision Asset Location with Considering Simultaneously Operating Piconets, Woon Yong Park (Soongsil University, Korea), Sungsoo Choi (KERI, Korea), Won Cheol Lee (Soongsil University, Korea) 2. Spectral Analysis and Performance Evaluation of One-chip VCXO with the Zig System, Dal-Hwan Yoon, Dong Ju Bae, Seung Woo Kim, Jeong Su Han (Semyung University, Korea) 3. Simulation of Interference Effects from UWB Sources to A Digital Narrowband Transmission System, Idnin Pasya, Atsushi Tomiki, Takehiko Kobayashi (Tokyo Denki University, Japan) 4. A Simple Asynchronous UWB Position Location Algorithm Based on Single Round-Trip Transmission, Dongwoo Kang, Young Namgoong, Suckchel Yang (Soongsil University, Korea), Sungsoo Choi (KERI, Korea), Yoan Shin (Soongsil University, Korea) 5. Analysis of Energy Efficiency for Low Power Transmission in WLAN with MIMO-OFDM and Block Ack Mechanism, Hoseok Choi, Sinchong Park (ICU, Korea) 		

Session 8B: Mobile Communications (VIII)	Room Ruby I
Chair: Dr. Tae Whan Yoo (ETRI, Korea)	
<ol style="list-style-type: none"> 1. A New Efficient BS Scheduler and Scheduling Algorithm in WiBro Systems, Juhee Kim, Eunkyung Kim, Kyung Soo Kim (ETRI, Korea) 2. Priority-based Call Admission Control of Multiclasses in Mobile Networks, Nguyen Cao Phuong (PTIT, Viet Nam), Sang-Ho Lee, Jung-Mo Moon (ETRI, Korea), Tran Hong Quan (PTIT, Viet Nam) 3. Efficient Fisheye State Routing Protocol using Virtual Grid in High-Density Ad-Hoc Networks, Ting-Hung Chiu, Shyh-In Hwang (Yuan Ze University, Taiwan) 4. Design, Development and Deployment of a Mobile E-Commerce Application for Rural South Africa – A Case Study, B Chipangura (University of Fort Hare, South Africa), A Terzoli (Rhodes University, South Africa), H Muyingi, G.S.V.R.Krishna Rao (University of Fort Hare, South Africa) 5. Flow-based Forwarding Scheme and Performance Analysis in Mobile IPv6 Networks, Doan Huy Cuong, Jun Kyun Choi (ICU, Korea), Dipnarayan Guha (Nanyang Technological University, Singapore) 	
Session 8C: Multimedia and Internet Systems and Services (VIII)	Room Ruby II
Chair: Dr. Suprava Patnaik (National Institute of Technology, India)	
<ol style="list-style-type: none"> 1. Implementation of a Real-time 3D Positioning Sound Synthesis Algorithm for a Handheld Device, Giwoo Park, Pinaki S. Chanda, Tae Ik Kang (LG Electronics, Korea) 2. Design and Implementation of Martini based Layer 2 VPN, Suncheul Kim, HoYong Ryu (ETRI, Korea) , Jaehyung Park (Chonnam National University, Korea) , TaeIl Kim (ETRI, Korea) 3. An Efficient Low Complexity Encoder for MPEG Advanced Audio Coding, Xiaopeng Hu, Guiming He, Xiaoping Zhou (Wuhan University, China) 4. Error Resilient MPEG-2 Video Coding Schemes Based on Three Layer Error Control Coding, Changseok Bae, Jeunwoo Lee (ETRI, Korea), Vera Chung (University of Sydney, Australia) 5. Improved Matching Algorithm for Services described by OWL-S, Moonyoung Chung (ETRI, Korea), Hyun Namgoong (UST, Korea), Kyung-Il Kim, Seungwoo Jung, HyeonSung Cho (ETRI, Korea) 	

Session 8D: Digital Home Technology (I) Chair: Dr. Yu-Hsiang Sheng (Industrial Technology Research Institute, Taiwan)	Room Diamond I
<ol style="list-style-type: none"> 1. Implementation of Initial Provisioning Function for Home Gateway Based on Open Service Gateway Initiative Platform, SangOk Lee, HoJin Park (ETRI, Korea) 2. A Personal Context-aware Universal Remote Controller for a Smart Home Environment, Youngjae Kim, Dongman Lee (ICU, Korea) 3. A Dynamic QoS Algorithm for Wireless AV Home Networks, Jianlin Guo, Jinyun Zhang, William Chen (Mitsubishi Electric Research Laboratories, USA) 4. A Media Distribution System supporting Priority-based QoS in a Home Network, Sung-Gi Choi, Dong-Oh Kang, Jeun-Woo Lee (ETRI, Korea) 5. Asynchronous Data Transfer on Wireless 1394 System, Seong Hee Park, Seong Hee Lee, Sang Sung Choi (ETRI, Korea) 	
Session 8E: Information Security Technology (VIII) Chair: Dr. Jaehoon Nah (ETRI, Korea)	Room Topaz I
<ol style="list-style-type: none"> 1. A Developing of Signature-based Network Security Tester for NGSS, Younseo Jeong (ETRI, Korea), Junsang Jeon (Hannam University, Korea), Jongho Ryu, Dongil Seo (ETRI, Korea) 2. A Computationally Secure Quantum Oblivious Transfer Scheme, Xin Lu (Graduate School of Chinese Academy of Sciences, China), Zhi Ma (Information Engineering University, China), Deng-Guo Feng (State Information Center, China) 3. Implementation of 10Giga VPN Accelerator Board, Ki Hyun Kim, Jang-Hee Yoo, Kyo Il Chung (ETRI, Korea) 4. A Simple Response Packet Confirmation Method for DRDoS Detection, Hiroshi Tsunoda, Yoshiaki Nemoto (Tohoku University, Japan), Kohei Ohta (Cyber Solutions Inc., Japan), Atsunori Yamamoto (NTT Data Corporation, Japan) 5. Denial-of-Service(DoS) Detection through Practical Entropy Estimation on Hierarchical Sensor Networks, Mihui Kim, Inshil Doh, Kijoon Chae (Ewha Womans University, Korea) 	

Session 8F: IT Service Technology (III)	Room Topaz II
Chair: Dr. Byoung Nam Lee (ETRI, Korea)	
<ol style="list-style-type: none"> 1. A Service Template Authoring Environment for URC Service Composition, Sangseung Kang, Joochan Sohn (ETRI, Korea) 2. A New Method for Ontology Merging based on Concept using WordNet, Miyoung Cho (Chosun University, Korea), Hanil Kim (Cheju University, Korea), Pankoo Kim (Chosun University, Korea) 3. Palmprint Matching using Line Features, Fang Li, Maylor K. H. Leung, Xiaozhou Yu (Nanyang Technological University, Singapore) 4. Comparisons analysis of Security Vulnerabilities for Security Enforcement in IPv4/IPv6, Hayoung Oh, Kijoon Chae (Ewha Womans University, Korea), HyoChan Bang, JungChan Na (ETRI, Korea) 5. Desktop Migration System Based on Dynamic Linking of Application Specific Libraries, Taein Hwang, Hojin Park (ETRI, Korea), Jin Wook Chung (Sungkyunkwan University, Korea) 	
Session 8G: Digital Broadcasting Technology (I)	Room Topaz III
Chair: Dr. Vladislav Pyattaev (LONIIS, Russian Federation)	
<ol style="list-style-type: none"> 1. Authorization Refreshment Management Using ARL in DTV Broadcasting, Han-Seung Koo, O-Hyung Kwon, Soo-In Lee (ETRI, Korea), Sung-Woong Ra (Chungnam National University, Korea) 2. Single Frequency Network Design of DVB-H (Digital Video Broadcasting – Handheld) System, Joo Chan Kim, Jin Young Kim (Kwangwoon University, Korea) 3. The Effects of Human Hands on the Radiation Characteristics of Offset-fed Slot Antenna Embedded at the Back of Display of Notebook Computers for the Reception of Digital Terrestrial TV Broadcasting, Muhammad Sajjadur Rahim, Tadahiko Maeda (Ritsumeikan University, Japan) 4. A Path Control Architecture for Receiving Various Multimedia Contents, Seong Yong Lim, Joo Myoung Seok, Han Kyu Lee (ETRI, Korea) 5. Extended DMB BWS for a User-Friendly Mobile Data Service, Heejeong Kim, Sora Park, Bongho Lee, Chunghyun Ann, YoungSung Son (ETRI, Korea) 	

Session 8H: Poster Session (II)	Room Diamond II
<ol style="list-style-type: none"> 1. A Novel QAM Joint Frequency-Phase Carrier Recovery Method, Qijia Liu, Zhixing Yang, Jian Song, Changyong Pan (Tsinghua University, China) 2. Simple Enhanced Overload Control Mechanism for Digital Exchange System, Bong Uk Bin, Kyu Chul Lee, Jong Hyup Lee (Inje University, Korea) 3. Design of Traffic Conditioner using Marking Algorithm on DiffServ-over-MPLS, Sanghyun Park, Jinwoo Lee (Konkuk University, Korea), Jintae Kim (Fivetek. Co., LTD., Korea), Inkap Park (Konkuk University, Korea) 4. Extended Service Registry for Distributed Computing Support in OSGi Architecture, Kyuchang Kang, Jeunwoo Lee (ETRI, Korea), Hoon Choi (Chungnam National University, Korea) 5. Challenges and Barriers in Implementing E-government: Investigation on NEIS of Korea, Yong Soon Kim (KERIS, Korea) 6. A Log-based Flash Translation Layer for Large NAND flash memory, Soo-Young Kim, Sung-In Jung (ETRI, Korea) 7. A Design and Implementation of ASIC for High-quality VoIP Terminal over Wireless LAN, Do Young Kim (ETRI, Korea), Jong Won Park (CNU, Korea) 8. An Application Level Gateway for Traversal of SIP Transactions through NATs, Jae Cheon Han, Wook Hyun, Sun Ok Park, Il Jin Lee, Mi Young Huh, Shin Gak Kang (ETRI, Korea) 9. Transmission Energy Efficiency in MIMO-OFDM based WLAN with HCCA Channel Access Scheme, Seungbeom Lee, Sin-Chong Park (ICU, Korea) 10. Baseball-shaped Circular Microstrip Antennas for Miniaturization, Mi-ra Ryu (Konkuk University, Korea), Jong-Myung Woo (CNU, Korea), Jung Hur (Konkuk University, Korea) 11. IPv6 Neighbor Discovery Protocol for Common Prefix Allocation in IEEE 802.16, Hongseok Jeon, Junghoon Jee (ETRI, Korea) 12. Key Factors for E-Commerce Business Success, Jaekyung Choi, Jeongsuk Park, Jeehyung Lee, Kyungsuk Ryu (ETRI, Korea) 13. The Design and Implementation of MAC Security in EPON, Kyeong-Soo Han, Kwang-Ok Kim, Tae Whan Yoo, Yul Kwon (ETRI, Korea) 14. An Improvement of Channel Efficiency for IEEE 802.15.3 High Rate WPAN, Ji Eun Kim, Young Ae Jeon, Sangjae Lee, Sang Sung Choi (ETRI, Korea) 15. Critical Design of the Ka-Band On-board Switching Transponder for Communication, Oceanographic, and Meteorological Satellite (COMS), Yong Min Lee, Seong Pal Lee (ETRI, Korea) 16. Consideration of Efficient Nearest Node Discovering Mechanisms for Key Infection, Jin-Bum Hwang, Young-Sik Hwang, Jong-Wook Han (ETRI, Korea) 	



TECHNICAL SESSIONS

Session 8H: Poster Session (II)	Room Diamond II
<ol style="list-style-type: none"> 17. A Study for Providing Personal Contents using Open API Platform, Hyun-Woo Oh, Kee-Seong Cho (ETRI, Korea) 18. Efficient VLSI Implementation of the List Sphere Decoder with Real-value Based Tree Searching Method, SangHo Seo, SinChong Park (ICU, Korea) 19. A Study on User Data Management for SIP-based IMPP Services, IlJin Lee, Wook Hyun, ShinGak Kang (ETRI, Korea) 20. Design and Performance Analysis of HomePNA 2.0 Transceiver Chip Circuit, Jong Won Kim, Jae Doo Huh (ETRI, Korea), Dae Young Kim (Chungnam National University, Korea) 21. Design of SPI module in Large-Scale Network, Seungyong Yoon, Jintae Oh, Jongsoo Jang (ETRI, Korea) 22. A Flexible Control Strategy on Workflow Modeling and Enacting, Jiantao Zhou, Xinming Ye (Inner Mongolia University, China) 23. Korean-English Named Entity Alignment for Machine Translation of Digital TV Closed Caption, Sanghwa Yuh (Kyungin Women's College, Korea), Jungyun Seo (Sogang University, Korea) 24. Key Distribution Scheme Based on Two Cryptosystems for Hierarchical Access Control, Bing Hu, Wu Ye, Sui-Li Feng (South China University of Technology, China), Xiao-Liang Wang (JiNan University, China), Xing Xie (GuangDong Information Center, China) 25. Paging Scheme for High-speed Portable Internet (HPi) System, Hyun Suk Roh, Sang-ho Lee (ETRI, Korea) 26. Secure Discovery Method of Devices for a Home Network Middleware, Do-Woo Kim, Geon-Woo Kim, Jun-Ho Lee, Jong-Wook Han (ETRI, Korea) 27. Performance Evaluation of Software Streaming Server Architecture for Massive Users, Sungjoo Kang, Kyong I Ku, Jeong Min Shim, Sung Jin Hur, Sang Hyun Ju, Wan Choi (ETRI, Korea) 28. Conversation Preference Profile for Mobile Web Service, Kangchan Lee, Wonsuk Lee, Jonghong Jeon, Seungyun Lee (ETRI, Korea), Jonghun Park (Seoul National University, Korea) 29. Recovery Policies on a Web Services-based Business Process for Minimizing Human Intervention, Jinyoung Moon, Rockwon Kim, Yeonjun Kim, Daha Lee, Hyeonsung Cho (ETRI, Korea) 30. Periodic Medium Reservation Timer Mechanism for VoIP in IEEE 802.11 Wireless LAN, Dae Ho Kim, Ki Jong Koo, Do Young Kim (ETRI, Korea) 31. A Study on Heuristic Algorithms to construct the Local Loop Connection, Jeongtae Kim, Soyoung Park, Tchanghee Hyun (ETRI, Korea) 32. A WDM-Ethernet hybrid Passive Optical Network Architecture, Jeong-Ju Yoo, Hyun-Ho Yun, Tae-Yeon Kim, Kang-Bog Lee, Mahn-Yong Park, Byoung-Whi Kim, Bong-Tae Kim (ETRI, Korea) 33. Storage structure and management skills for RDF Schema versioning in RDB environment, ByungGon Kim (Bucheon College, Korea), YounHee Kim, Haechull Lim (Hongik University, Korea) 	
Coffee Break 16:20 ~ 16:40	

Session 9 16:40 ~ 18:00	
Session 9A: CDMA & Wireless Communications (IX) Chair: Dr. Hee-Chang Chung (NCA, Korea)	Room Emerald
<ol style="list-style-type: none"> 1. Spectral Correlation Based Signal Detection Method for Spectrum Sensing in IEEE 802.22 WRAN Systems, Ning Han, SungHwan Shon, Jae Hak Chung, Jae Moun Kim (Inha University, Korea) 2. A Mixed-Radix 4-2 Butterfly with Simple Bit Reversing for Ordering the Output Sequences, Young-jin Moon, Young-il Kim (ETRI, Korea) 3. Asynchronous Uplink MC-CDMA with Multiuser Detection and Frequency Offset, Won Mee Jang, Moon Woo Lee (University of Nebraska, USA) 4. General Expression for the Error Probability of Arbitrary Two-Dimensional Signaling with I/Q Amplitude and Phase Unbalances, Jaeyoon Lee, Dongweon Yoon, In Chul Im (Hanyang University, Korea) 5. Novel Techniques of a List Sphere Decoder for High Throughput, Jin Lee, Sin-Chong Park (ICU, Korea) 	
Session 9B: Mobile Communications (IX) Chair: Prof. Il Young Moon (Korea University of Technology & Education, Korea)	Room Ruby I
<ol style="list-style-type: none"> 1. A Handover Framework for Seamless Service Support between Wired and Wireless Networks, Ok Sik Yang (ICU, Korea), Seong Gon Choi (CBNU, Korea), Jun Kyun Choi (ICU, Korea), Jung Soo Park, Hyoung Jun Kim (ETRI, Korea) 2. Communication Technologies for Collaborative Sensing and Control in Vehicular Ad-Hoc Networks, Evtim Peytchev, Taha Osman, David Al-Dabass, Michael Thomas, Shi Zhi (Nottingham Trent University, United Kingdom) 3. Considerations of Multiple Network Interface for a Mobile node, Yong-Geun Hong, Jung-Soo Park, Hyoung-Jun Kim (ETRI, Korea) 4. The Framework for Mobility and Multihoming Using Overlay Network, Taewan You, Seungyun Lee (ETRI, Korea) 5. A New Backoff Scheme of IEEE 802.11 Wireless Local Area Networks, Il-Young Moon (Korea University of Technology and Education, Korea), Hwi-Jin Ye, Sung-Joon Cho (Graduate School of Hankuk Aviation University, Korea) 	

Session 9C: Multimedia and Internet Systems and Services (IX) Chair: Mr. Do Young Kim (ETRI, Korea)	Room Ruby II
<ol style="list-style-type: none"> 1. The Design of the Ontology Retrieval System on the Web, Myunggwon Hwang, Hyunjang Kong, Pankoo Kim (Chosun University, Korea) 2. PEAQ-based Psychoacoustic Model for Perceptual Audio Coder, Xiaopeng Hu, Guiming He, Xiaoping Zhou (Wuhan University, China) 3. Gesture Analysis for Human-Robot Interaction, Kye Kyung Kim, Keun Chang Kwak, Su Young Chi (ETRI, Korea) 4. RLS Algorithm Based Sub-Band Decomposition Low Memory Multimedia Applications, Suprava Patnaik, Yogananda Patnaik, Anamika Upadhy (National Institute of Technology, India) 5. Packet Control Mechanism for Seamless Multimedia Streaming Service in Wireless Network, Hyung Su Lee, Hee Young Youn (Sungkyunkwan University, Korea), Hye Dong Jung (KETI, Korea) 	
Session 9D: Digital Home Technology (II) Chair: Dr. Jianlin Guo (Mitsubishi Electric Research Laboratories, USA)	Room Diamond I
<ol style="list-style-type: none"> 1. A Scheme Using OPES for Real-Time Translation Services in Digital Home Networks Based on Delivery Management Systems, Il-Woo Lee, Ho-Jin Park, Kwang-Roh Park (ETRI, Korea), Younghwan Choi, Sang-Ha Kim (Chungnam National University, Korea) 2. Augmented Interface Table based on Fingertip Recognition for Embedded Devices, Sung-Ho Ahn, Ji-Yong Kim, Ji-Young Kwak (ETRI, Korea), Jee In Kim, Doo Hyun Kim (Konkuk University, Korea) 3. Integrate LonWorks and UPnP devices by OSGi gateway and Universal Remote Console, Yu-Hsiang Sheng, Wen-Wei Lin, Chia-Shou Tu, Kuen-Ming Lee (Industrial Technology Research Institute, Taiwan) 4. Context-Aware based Mobile Service for Ubiquitous Home, Hyunjeong Lee, Jongwon Kim, Jaedoo Huh (ETRI, Korea) 5. The DLNA Proxy System Architecture for Sharing In-Home Media Contents via Internet, Yeon-Joo Oh, Hoon-Ki Lee, Jung-Tae Kim, Eui-Hyun Paik, Kwang-Roh Park (ETRI, Korea) 	

Session 9E: ASP, WAS, P2P, CDN, and XML Technologies Chair: Dr. Chin-Chen Wang (Yuan Ze University, Taiwan)	Room Topaz I
<ol style="list-style-type: none"> 1. Performance evaluation of Open Source Native XML databases – A Case Study, Ntima Mabanza, Jim Chadwick, G.S.V.R.Krishna Rao (University of Fort Hare, South Africa) 2. P2MVID: Peer-to-Peer Mobile Video On-Demand, Katsuhiko Sato (Japan Radio Co., Ltd., Japan), Michiaki Katsumoto (National Institute of Information and Communications Technology, Japan), Tetsuya Miki (The University of Electro-Communications, Japan) 3. The Index Organizations for RDF and RDF Schema, YounHee Kim (Hong-Ik University, Korea), ByungGon Kim (Bucheon College, Korea), HaeChull Lim (Hong-Ik University, Korea) 4. An Overlay Resource Monitor System, Chih-Chen Wang, Yung-Mu Chen, Cheng-Hao Weng, Tein-Yaw Chung (Yuan Ze University, Taiwan) 5. Contents Conversion Service Network, Heang-Suk Oh, Teak-Yong Nam (ETRI, Korea) 	
Session 9F: IT Service Technology (IV) Chair: Mr. Kyu Ouk Lee (ETRI, Korea)	Room Topaz II
<ol style="list-style-type: none"> 1. Design and Implementation of Session Management for n-to-n Multicast, Okjo Jung, Juyoung Park, ShinGak Kang (ETRI, Korea) 2. Modeling of Heart Phantom using the Multidipole Current Source, Dal-Hwan Yoon, Sun Hyo Lee, Dong Ju Bae, Ho Kyun Kim (Semyung University, Korea) 3. 3D Sound Localization Cues using HRTF Database Built with Dummy Head, Alexander Ovcharenko, Ui-Pil Chong (University of Ulsan, Korea) 4. Design and Implementation of Real-Time Security Guard Robot using CDMA Networking, Je-Goon Ryu (Korea Polytechnic University, Korea), Hyeon-Min Shim, Se-Kee Kil (Korea Polytechnic University, Korea), Eung-Hyuk Lee (Korea Polytechnic University, Korea), Heung-Ho Choi (Inje University, Korea), Seung-Hong Hong (Inha University, Korea) 5. A study on the Service Process Generation System for Intelligent Robot, Cheonshu Park, Joochan Sohn (ETRI, Korea) 	



TECHNICAL SESSIONS

Session 9G: Digital Broadcasting Technology (II)

Room Topaz III

Chair: Mr. Muhammad Sajjadur Rahim (Ritsumeikan University, Japan)

1. High Speed MPEG-2 TS Scrambling System with DVB-Common Scrambling Algorithm, Joon-Young Jung, O-Hyung Kwon, Soo-In Lee (ETRI, Korea)
2. Performance Enhancement of a DBS receiver using Hybrid Approaches in a Real-Time Environment, Sung-Hoon Kim (ETRI, Korea), Yeong Rak Seong, Kyeong Hoon Jung, Dong Wook Kang, Ki-Doo Kim (Kookmin University, Korea)
3. Nonlinear Filtering for Rejection ISI in FSK Modulation, Mohammad Reza Tarihi, Asghar Taheri (Malek Ashtar University of Technology, Iran), Kamal Mohamed-Pour (K. N. Toosi University of Technology, Iran)
4. The Interactive Contents Authoring System for Terrestrial Digital Multimedia Broadcasting, Won-Sik Cheong, Jihun Cha, YeSun Joung, Kyuheon Kim (ETRI, Korea)
5. An Efficient Method of Personalized Broadcasting on the Interactive Broadcast Network, Joo-Myoung Seok, Seong Yong Lim, Heekyung Lee, Han-Kyu Lee (ETRI, Korea)



TECHNICAL SESSIONS

Day 3 : February 22 (Wednesday)

Session 10 09:00 ~ 10:20

Session 10A: CDMA & Wireless Communications (X)

Room Emerald

Chair: Prof. Seung-Hoon Hwang (Dongguk University, Korea)

1. Low Complexity MMSE-QRD-based ML Decoder for Quasi-Orthogonal STBC scheme in MIMO Wireless Communications Systems with Four-Transmit Antennas, Van-Su Pham, Minh-Tuan Le, Linh Mai, Giwan Yoon (ICU, Korea)
2. Low-Complexity Generalized Layered Space-Time MIMO Detection, Yuhei Nagao, Masayuki Kurosaki, Hiroshi Ochi (Kyushu Institute of Technology, Japan)
3. The Optimization of the Collision Resolution Algorithm for Broadband Wireless Access Network, Sung-Min Oh, Jae-Hyun Kim (Ajou University, Korea)
4. A Robustness Analysis of a Practical Contention Resolution Algorithm under Misbehaved users in Wireless Communication Systems, Chalotorn Chanasong, Warakorn Srichavengsup, Lunchakorn Wuttisittikulij (Chulalongkorn University, Thailand)
5. A Optimal CF-Poll Piggyback Scheme in IEEE 802.11e HCCA, Hyun-Jin Lee, Jae-Hyun Kim (Ajou University, Korea)

Session 10B: Mobile Communications (X)

Room Ruby I

Chair: Mr. Hyoung Jun Kim (ETRI, Korea)

1. Keep-Alive Algorithm based Periodic Ranging Code Group for detecting abnormal SS in WiBro System, Sook-Jin Lee (ETRI, Korea), Whan Woo Kim (Chung-Nam National University, Korea)
2. Energy-based Route Discovery Mechanism in Mobile Ad Hoc Networks, Jirasak Kanjanarot, Kowit Sitthi, Chaiyachet Saivichit (Chulalongkorn University, Thailand)
3. Intermediary based Architecture for Mobile Web Services, Wonsuk Lee, Kangchan Lee, Seungyun Lee (ETRI, Korea)
4. The Applicability of SCTP to Mobile Ad Hoc Networks, Dongkyun Kim, Jeomki Song, Jounsik Kim, Hongseok Yoo (Kyungpook National University, Korea), Jungsoo Park (ETRI, Korea), Juan-Carlos Cano (Polytechnic University of Valencia, Spain)
5. Route Optimization Using RIPng Protocol in Nested Network Mobility, Sung Hei Kim, Yoon Young Ahn (ETRI, Korea), Sang Ha Kim (ChungNam National University, Korea), Tae Il Kim (ETRI, Korea)

Session 10C: IPv6 Technology (I) Chair: Dr. Myung Ki Shin (ETRI, Korea)	Room Ruby II
<ol style="list-style-type: none"> 1. An Empirical Analysis of IPv6 Transition Mechanisms, Myung-Ki Shin, Hyoung-Jun Kim (ETRI, Korea), Darrin Santay, Doug Montgomery (NIST, USA) 2. Network Side Fast handover Support in Mobile IPv6, HeeYoung Jung, HongSeok Jeon (ETRI, Korea) 3. Design, Implementation and Evaluation of Source-Specific Multicast System over IPv6 Networks, Sangjin Jeong, Myung-Ki Shin, Hyoung-Jun Kim (ETRI, Korea) 4. Protection Algorithm against Security Holes of IPv6 Routing Header, JaeDeok Lim, YoungKi Kim (ETRI, Korea) 5. An Efficient Mechanism for Multicast Deployment in IPv6, Min-kyo In, Seung-yun Lee, In-dong Jang, Tae-wan You (ETRI, Korea) 	
Session 10D: Communication Network Topology & Planning (I) Chair: Mr. Chan Kim (ETRI, Korea)	Room Diamond I
<ol style="list-style-type: none"> 1. Comparison of Cost for Different Coverage Scenarios between Copper and Fiber Access Networks, Michael Jensen, Rasmus Hjorth Nielsen, Ole Brun Madsen (Aalborg University, Denmark) 2. Internet Topology Modeling which Reflects Hierarchical and Dynamic Characteristic of Internet, Ju-hang Sohn, Jung-ryul Kim, Joo-seong Park, Hyo-jun Lee, Min-taig Kim (ETRI, Korea) 3. Demonopolization of Russian Long Distance Communication Market using SS 7 Network, Oleg Semanov (North-West Telecom, Russian Federation), Vladislav Pyattaev (FSUE LONIIS, Russian Federation), Vitaly Danilov (St. Petersburg State University of Telecommunications, Russian Federation) 4. Content-based Pattern Matching for Classification of Network Application, Kwangjin Choi, Jun-kyun Choi (ICU, Korea), Sangyong Ha (NCA, Korea), Se Yun Ban (ICU, Korea) 5. Intrinsic Fitness and Preferential Attachment in Scale-free Networks, Hongbo Liu, Jiaxin Wang (Tsinghua University, China) 	

Session 10E: GRID, Distributed Computing Technologies & Services (I)	
Chair: Mr. Kamrul Hasan Talukder (Hiroshima University, Japan)	
Room Topaz I	
<ol style="list-style-type: none"> 1. Work Packet Manager: Exploiting Heterogeneity in Cluster Computing, KyuHo Lee, Jongsu Yi, JunSeong Kim (Chung-Ang University, Korea) 2. Load Balancing of OLTP on Heterogeneous Database Cluster, Weihua Gong, Yuanzhen Wang (Huazhong University of Science and Technology, China) 3. A Method for Representing and Transporting CIM Operations using Binary XML in the WBEM Architecture, Jong-Geun Park, Chang-Won Ahn, Hee-Nam Cho, Il-Soo Byun, Frederic Desmons, Seong-Woon Kim (ETRI, Korea) 4. Implicit Information Load Sharing Policy for Grid Computing Environment, Natthakrit Sanguandikul, Natawut Nupairoj (Chulalongkorn University, Thailand) 5. Lifetime Maximization by Cross-Layer Interaction in Wireless Sensor Networks, In-Yeup Kong (Pusan National University, Korea), Won-Joo Hwang (Inje University, Korea) 	
Session 10F: Portable Internet and Internet Telephony	
Chair: Prof. Jin-Seek Choi (Hanyang University, Korea)	
Room Topaz II	
<ol style="list-style-type: none"> 1. Design and Development of the Intelligent SSW and SIP Application Server System, Kwihoon Kim, Hyun-Woo Lee, Won Ryu (ETRI, Korea) 2. Policy Analysis and Studies on a Model for Determining an Optimal VoIP Access Charge, Sung Uk Park (KISTI, Korea) 3. Application Method of QoS, IPv6, Security in Wibro, Kyu Ouk Lee, Jin Ho Hahm, Young Sun Kim (ETRI, Korea) 4. Complexity Analysis of a Dual Round-Robin based iSLIP (DiSLIP) Scheduling Scheme, Jin Seek Choi (Hanyang University, Korea), Mijeong Yang, Tae Il Kim (ETRI, Korea) 5. A Emergency Call Service Mechanism on SIP Internet Telephony System, Sun Ok Park, Jae Cheon Han, Wook Hyun, Mi-Young Huh, Shin Gak Kang (ETRI, Korea) 	
Coffee Break 10:20 ~ 10:40	

Session 11 10:40 ~ 12:00	
Session 11A: CDMA & Wireless Communications (XI)	Room Emerald
Chair: Prof. Hiroshi Ochi (Kyushu Institute of Technology, Japan)	
<ol style="list-style-type: none"> 1. Impact of the Antenna Shuffling in V-BLAST System using NAK for H-ARQ in Correlated Fading Channels, Bonghoe Kim (LG Electronics, Korea), Seung-Hoon Hwang (Dongguk University, Korea) 2. Finite Element based Beam Propagation Method for 3D Wave Propagation in Troposphere, Kamran Arshad, Ferdinand Katsriku, Aboubaker Lasebae (Middlesex University, United Kingdom) 3. A MIMO-OFDM System with Simple Bit Allocation and Spatial Resource Grouping Based Beamforming, Daejin Park, Suckchel Yang, Yoan Shin (Soongsil University, Korea) 4. Compensation of the OFDM Non-linear Distortions by the Inverse Model Method, Rafik Zayani, Rim Guedria, Ridha Bouallegue (ISI, Tunisia) 5. Iteration Based Performance Evaluation of LDPC coded MIMO-OFDM, Hyounghoon Kim, SinChong Park (ICU, Korea) 	
Session 11B: Network Management, Operation and Maintenance	Room Ruby I
Chair: Dr. Thang Viet Nguyen (Kyoto Institute of Technology, Japan)	
<ol style="list-style-type: none"> 1. Review on QoS issues in IEEE 802.11 W-LAN, Jaekyung Choi, Jeongsuk Park, Jeehyung Lee, Kyungsuk Ryu (ETRI, Korea) 2. The Study on SLA Metrics and System Architecture for IP TV, Seong Hwan Kim, Gil Haeng Lee (ETRI, Korea) 3. Adaptive One Increased-Order Deadbeat Congestion Control Algorithm for ABR Traffic in ATM Networks, Thang Viet Nguyen, Takehiro Mori, Yoshihiro Mori (Kyoto Institute of Technology, Japan) 4. The Design of Dynamic Authorization Model for User centric service in Mobile Environment, Byunggil Lee, Howon Kim, Kyoil Chung (ETRI, Korea) 5. Constructing the Channelized Interface on the Next-Generation SONET/SDH System, Seung-Woo Hong, Byung-Ho Yae (ETRI, Korea) 	

Session 11C: IPv6 Technology (II)	Room Ruby II
Chair: Mr. Kyu Ouk Lee (ETRI, Korea)	
<ol style="list-style-type: none"> 1. Implementation Issues for IPv6 Software Forwarding in Routing System, Hyun Joo Kang, Yoon Young Ahn, Sung Hei Kim, Byung Ho Yae (ETRI, Korea) 2. On IPv6 Traceback, Syed Obaid Amin, Choong Seon Hong (Kyung Hee University, Korea) 3. IPv6 Multihoming for NGN, Hyoung-Jun Kim, Yong-Geun Hong (ETRI, Korea), Sang-Ha Kim (Chungnam National University, Korea) 4. A Scalable Global IPv6 Anycast Routing Support Mechanism, Jong Min Lee, Dipnarayan Guha, Jun Kyun Choi (ICU, Korea), Jung Soo Park, Hyoung Jun Kim (ETRI, Korea) 5. IPv4/IPv6 Forwarding Control Architecture in Distributed Router, Yoo-Hwa Kang, Tae-Il Kim (ETRI, Korea) 	
Session 11D: Communication Network Topology & Planning (II)	Room Diamond I
Chair: Dr. Michael Jensen (Aalborg University, Denmark)	
<ol style="list-style-type: none"> 1. Source-based Multiple Gateway Selection Routing Protocol in Ad-hoc Networks, Byung-jin Lee, Soon-Gyu Jeong, Sang-jo Yoo (Inha University, Korea) 2. Investigation of Cost Reductions through Synergy Effects when Delpoying Commercial WANs, Rasmus Hjorth Nielsen, Michael Jensen, Ole Brun Madsen (Aalborg University, Denmark) 3. Performance Analysis of Cooperative Communications Protocol using Sum-Product Algorithm for Wireless Relay Networks, Ho Van Khuong, Hyung-Yun Kong (University of Ulsan, Korea) 4. Five Novel Selection Policies for N2R Network Structures, Jens Myrup Pedersen, Tahir M. Riaz, Ole Brun Madsen (Aalborg University, Denmark) 5. The System Integration of DRM and Fingerprinting, Jung-Soo Lee, Ki-Song Yoon (ETRI, Korea) 	

Session 11E: GRID, Distributed Computing Technologies & Services (II) Room Topaz I
Chair: Prof. Jin-Seek Choi (Hanyang University, Korea)

1. A LanLinux-Based Grid System for Bioinformatics Applications, Tae-Kyung Kim, Sang-Keun Oh, Wan-Sup Cho (Chungbuk National University, Korea)
2. Modeling and Verification of Some Communication Protocols, Kamrul Hasan Talukder, Koichi Harada (Hiroshima University, Japan)
3. Effective Semantic Web Services Discovery using Usability, Hyun Namgoong (UST, Korea), Moonyoung Chung, Kyoung-il Kim (ETRI, Korea), HyeonSung Cho, Yunku Chung (UST, Korea)
4. Block-Based Grid Caching for Grid Datafarm, Teerayut Hiruntaraporn, Natawut Nupairoj (Chulalongkorn University, Thailand)
5. Design and Implementation of the Script-based Service Deployment Solution, Wonjae Lee, Yuhyeon Bak, Sangmin Woo, Changsoo Kim, Okgi Min, Hak-Young Kim (ETRI, Korea)

Session 11F: E-Commerce and M-Commerce Room Topaz II
Chair: Dr. Sergio Ochoa (University of Chile, Chile)

1. Design and Implementation of RDBAC Framework for Privacy on NEIS, Yong Soon Kim (KERIS, Korea), Eui Kyeong Hong (University of Seoul City, Korea)
2. Development of a localized E-Commerce Platform for Music using Indigenous Knowledge -A South African Experience, Gary O.G Ndlovu, Alfredo Terzoli, Alvin Petersen, Hippolyte Muyingi, G.S.V.R.Krishna Rao (University of Fort Hare, South Africa)
3. A Software Architecture to Support Digital Document Interchange for the Chilean Government, Sergio F. Ochoa, Pedro O. Rossel, María Cecilia Bastarrica (University of Chile, Chile)
4. From Detecting to Recognizing Color Codes, Jaehwan Park (Sangmyung University, Korea), Woosung Kim (Hoseo University, Korea), Hyeon-Joong Yoo, Youngbum Jang (Sangmyung University, Korea)
5. Smart Card initiative for South African E-Governance – A Study, Peter T. Nkomo (University of Fort Hare, South Africa), Alfredo Terzoli (Rhodes University, South Africa), Hippolyte Muyingi, G.S.V.R.Krishna Rao (University of Fort Hare, South Africa)



REGISTRATION

<http://icact.org/registration/registration.asp>

- **Pre-registration period is from Dec. 12, 2005 to Jan. 20, 2006.**

(But the pre-registration of general participants, who are not main authors or speakers of ICACT2006, is allowed by Feb. 15, 2006.)

- In case of payment with credit card or wire-transfer, the remitter must be identified exactly by the name of author or attendee.

- Otherwise, you should additionally inform the remitter's name and wire-transfer confirmation document by email to registration@icact.org

- **You should request the notarized invitation letter at the same process of pre-registration by Jan. 6, 2006 in advance.**

- Because it may take a long time to receive by postal mail, we should prepare the notarized documents previously.

- Please take notice that US \$30, which is additional fee for notarization and relevant postal service, will be charged.

	Foreign Participant		Domestic Participant	
	CD-ROM only	CD-ROM and Technical Proceedings	CD-ROM only	CD-ROM and Technical Proceedings
Pre-registration	US \$450	US \$500	450,000	500,000
On Site Registration	US \$550	US \$600	550,000	600,000
Full Time Student Pre-registration	US \$350	US \$400	350,000	400,000
Full Time Student On Site Registration	US \$450	US \$500	450,000	500,000
Additional Proceeding	US \$50		50,000	
Additional CD-ROM	US \$50		50,000	
Notarization Fee (for Invitation Letter)	US \$30		30,000	



VENUE

Accommodation Fees

- Participants who completed registration and approval will be able to make reservations at a special conference rate.
 - **Standard hotel:** 95,000 Korea Won/ about 95 USD
(Standard number of person: 2, normal room rate: 280,000 Korea Won)
 - **Condominium** (66 square meters): 90,000 Korea Won/ about 90 USD
(Standard number of person: 4, normal room rate: 240,000 Korea Won)
 - **Youth Hostel:** 90,000 Korea Won/ about 90 USD
(Standard number of person: 8, normal room rate: 160,000 Korea Won)

NOTICE

- The indicated room rate is for one room per one night which contains SURTAX and Service charge.
(Exchange Rate: About 1,000 Korea Won to the US dollar)
- **To foreign participants, special conference rates are applicable for Feb. 19-23. 2006**
(To native participants, reduced room rates are applicable for Feb. 19-22. 2006)
- **In order to make reservations, please download at <http://icact.org/download/hotel2006.doc> and fill the document of the file ([hotel2006.doc](#)).**
- **Then e-mail the document to the address below.**

E-mail: member@pp.co.kr

Tel: +82-2-508-3400

PHOENIX PARK (<http://phoenixpark.co.kr/english/default.html>)

Phoenix Park, spread out on 16.5 million square meters, is a luxurious, world-class resort set in the picturesque mountains of Gangwon province.

Throughout the year, we provide the best service and personal care to satisfy the needs of our guests in our deluxe hotels and condos and their recreational desires in our leisure facilities and on our ski slopes. No matter your age, fancy, or favorite pastime, there is always something for you to enjoy at Phoenix Park. Our facilities vary to provide all the comforts and wishes for the perfect family vacation or for the romantic getaway for young lovers.

The Phoenix Park experience is unforgettable for everyone. The amount of joy and excitement in the natural setting of Phoenix Park is unimaginable!!

Hotel

The hotel is conveniently located at the base of the mountain, so the guests have easy access to the ski slopes. The rooms are categorized as Korean style, western style, family oriented, VIP, and Royal suite. In addition, for your convenience, there are private ski lockers for each room in the lobby of the hotel.

CONFERENCE - SITE FLOORS

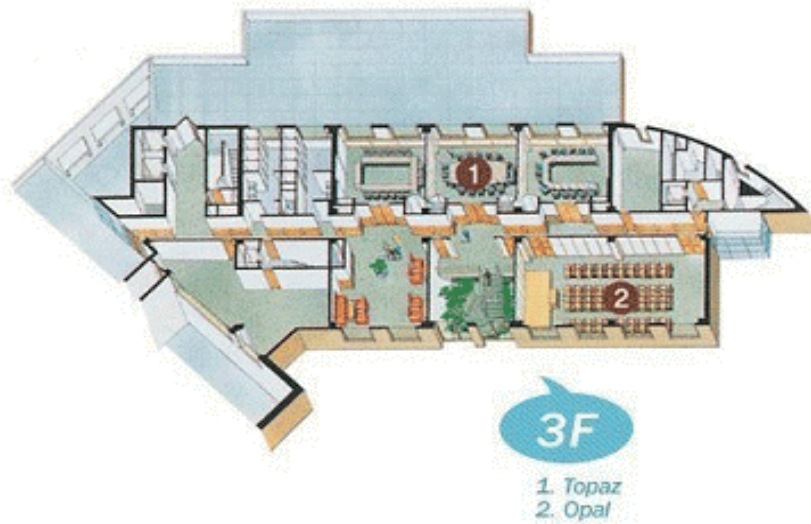

TRANSPORTATIONS (by Bus)

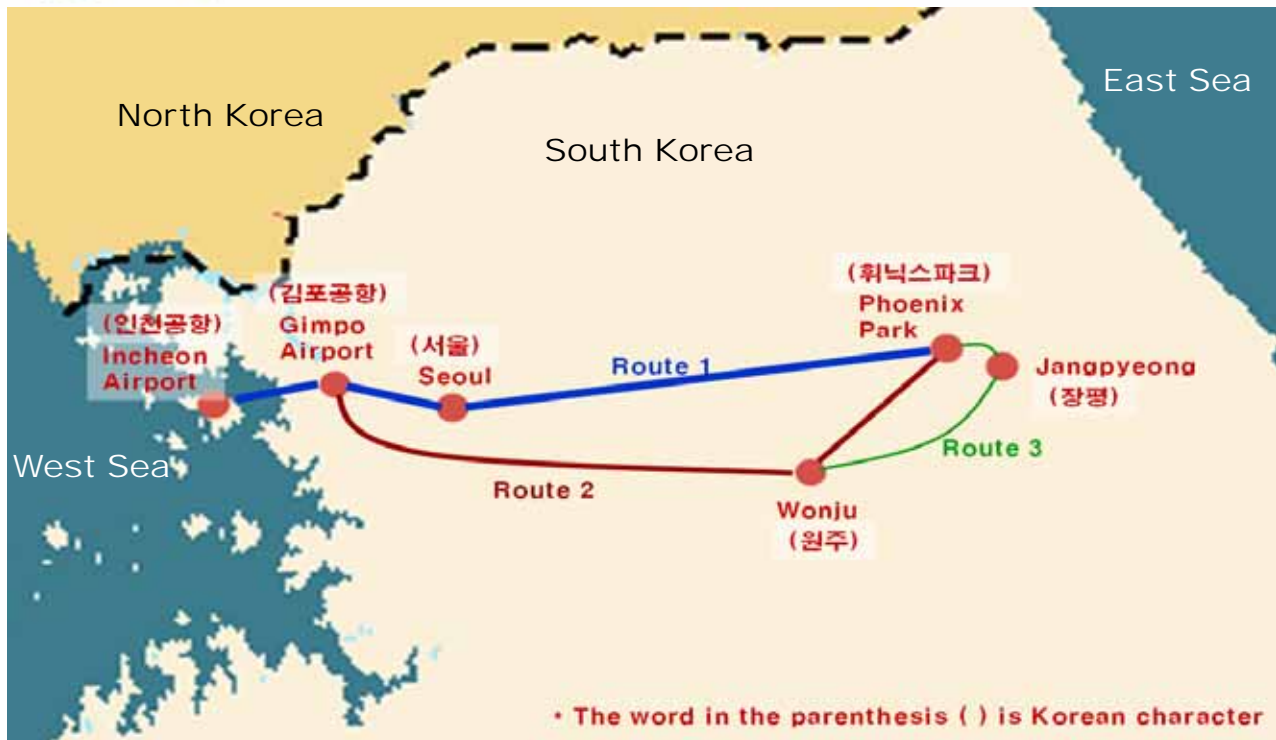

Route 1 : 4hrs 10mins

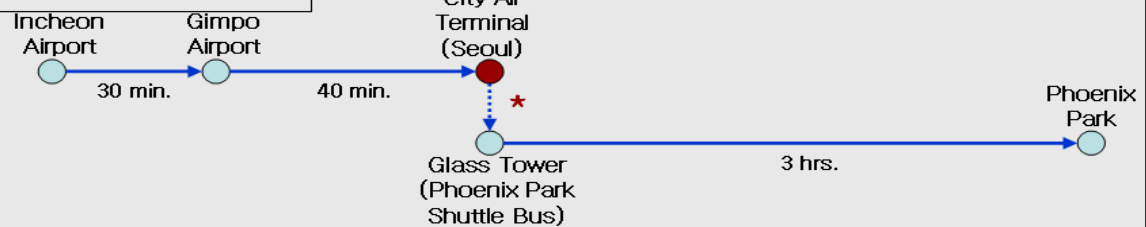

Route 2 : 3hrs 30mins

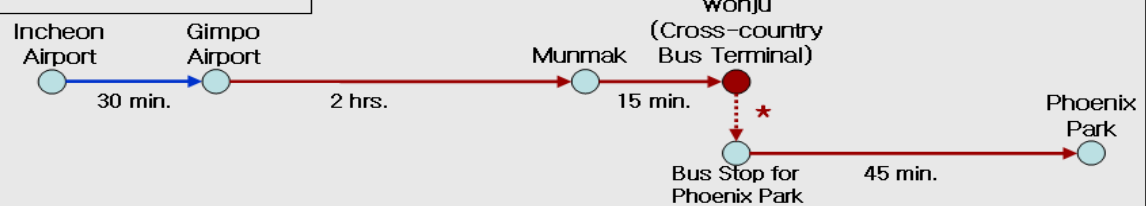

Route 3 : 3hrs 50mins

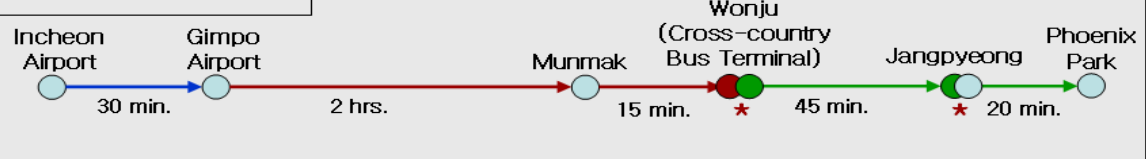

You should transfer the bus where star mark (★) is indicated, and the total time for each route does not include the time caused by transfer because it may be different case by case.

Incheon Airport Arrival Floor

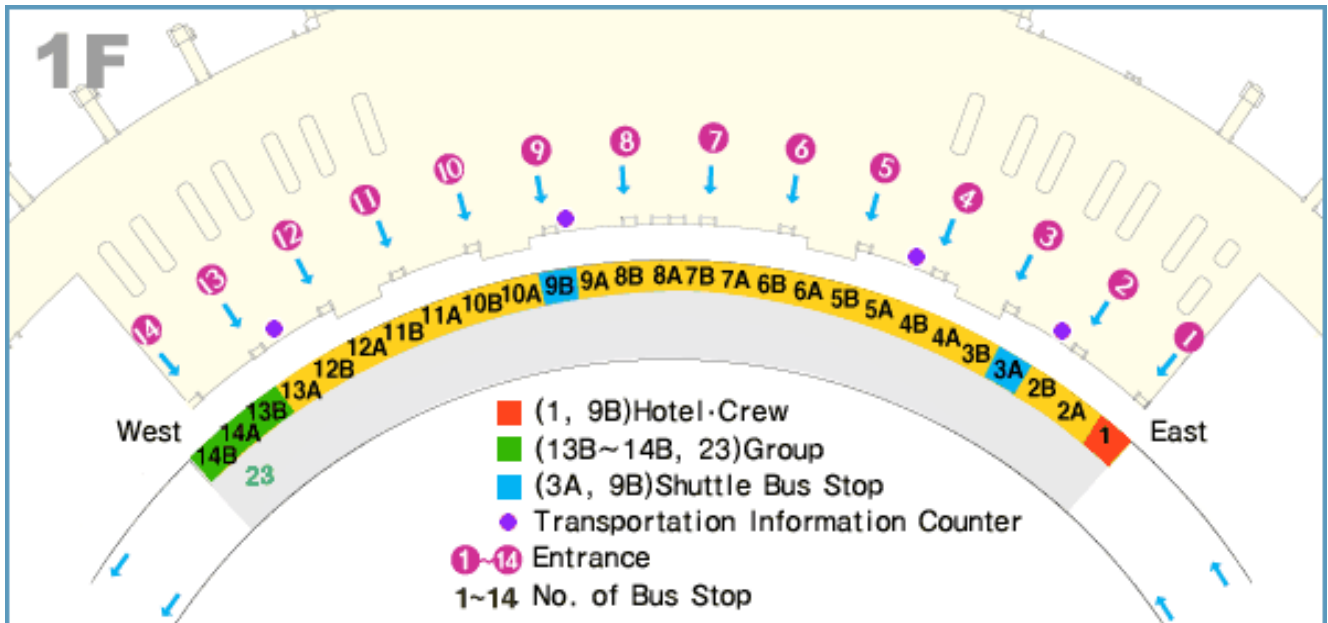

You may get informations on limousines and buses, and you can purchase all kinds of the bus ticket at the [Transportation information Counter](#) (4 violet-colored spots ● near the exit No. 2, 4, 9, 13) on arrival floor of passenger terminal.

● GENERAL BUS TICKET COUNTER LOCATED AT INDOOR OF ARRIVAL FLOOR



Also you may purchase bus tickets at the designated counters in the passenger terminal, but you could not purchase some tickets, e.g. for KAL Limusine bus, at the small ticket counter located outdoors.

Route 1

Incheon Airport ↔ (Gimpo Airport) ↔ **Seoul** (Korea City Air Terminal, Samseong-dong)
 ←(**transfer**)→ **Seoul** (Glass Tower, Samseong-dong) ↔ **Phoenix Park**

● Bus Stop 3B and Ticket Booth



● Outdoor Bus Ticket Counter



● Bus Stop 10B and Ticket Booth



Incheon Airport ↔ (via Gimpo Airport) ↔ Seoul (Korea City Air Terminal, Samseong-dong)				
First Bus		Last Bus		Remark
Incheon	Samsung-dong	Incheon	Samsung-dong	Departure Bus Stop : 3B, 10B Travel Time : 60 ~ 80 minutes Departure Time Interval : Every 10 ~ 15 minutes One-way Fare : 13,000won (Round-trip fare : 23,000won)
05:20	05:30	20:00	22:30	
Gimpo Airport ↔ Seoul (Korea City Air Terminal, Samseong-dong)				
First Bus		Last Bus		Remark
Gimpo	Samsung-dong	Gimpo	Samsung-dong	Travel Time : 40 ~ 60 minutes Departure Time interval : Every 10 minutes One-way Fare : 6,000won
07:30	05:30	22:20	20:00	

TRANSPORTATIONS (by Bus)

(TRANSFER) : It takes about 10 minutes on foot between **Korea City Air Terminal** and **Glass Tower**

- EXIT of KCAT Arrival Platform(2F)
- City Air Terminal Information Desk
- Escalator(2F B1) at Information Desk



When you get off the bus and pass the auto-door EXIT, you will find a KCAT Information Desk where you can get some information. You can come down to B1 floor connected to the COEX MALL by using the escalator just at the left side of the KCAT Information desk.

- Map between **City Air Terminal** and **Glass Tower Bus Stop** for Phoenix Park around Samseong Subway Station

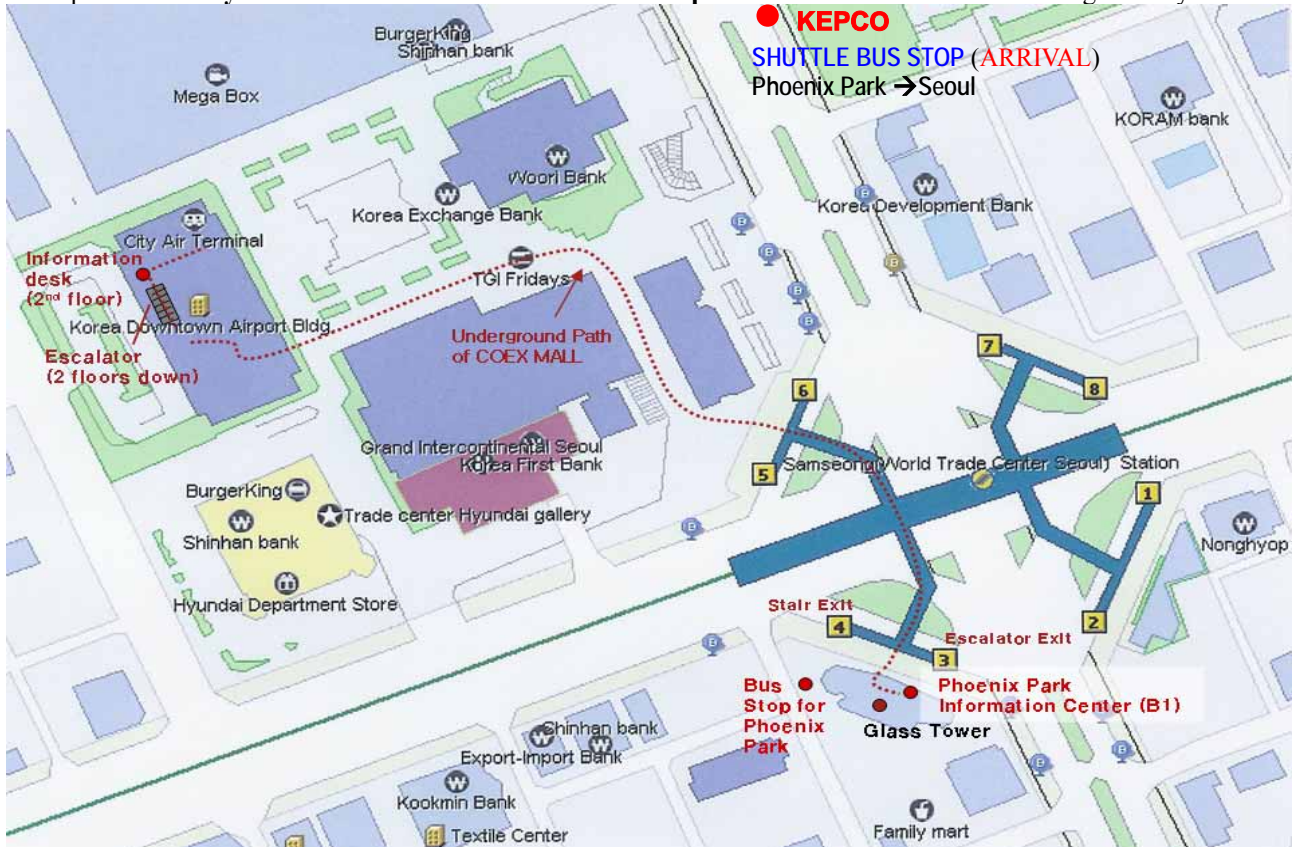

When you come down from 2nd Floor to B1 floor of KCAT (Korea City Air Terminal), you can move to the Phoenix Park Information Center (B1 floor) in Glass Tower Building through the underground path of COEX MALL and SAMSEONG SUBWAY STATION.

If you want to visit the Phoenix Park Information Center, it is convenient to enter the Glass Tower Building (B1 floor) directly through the underground gate between EXIT 3 and EXIT 4.

Otherwise, if you'd like to come to the Bus Stop for Phoenix Park directly, you can pass the EXIT 3 (escalator) or EXIT 4 (stair) and go to the Bus Stop for Phoenix Park.

TRANSPORTATIONS (by Bus)

- Phoenix Park Information Office at Glass Tower(B1)



- Gate of the Glass Tower Building



- Exit 4 of the Samseong Subway Station



- Glass Tower Bus Stop for Phoenix Park



- Shuttle Bus for Phoenix Park





TRANSPORTATIONS (by Bus)

Seoul (Glass Tower , Samseong-dong)		Phoenix Park
Departure Place	Departure Time	Remark
Glass Tower (Samseong Subway Station : Exit 3 or 4)	(MON ~ THU) 08:00, 10:00, 13:00, 16:00, 20:00 (FRI) 08:00, 10:00, 13:00, 16:00, 20:00, 22:00 (SAT) 06:00, 08:00, 10:00, 13:00, 16:00, 20:00, 22:00 (SUN) 06:00, 08:00, 10:00, 13:00, 16:00, 20:00	One-way Fare : Adult : 13,000 won Children : 8,000 won Round-trip Fare : Adult : 24,000 won Children : 15,000 won

● Phoenix Park Hotel (ICACT 2006 Conference Site)



● Shuttle Bus Terminal at Phoenix Park



Phoenix Park		Seoul (KEPCO , Samsung-dong)
Departure Place	Departure Time	Remark
Phoenix Park (Ski House Parking Lot)	(MON ~ FRI) 09:30, 13:00, 17:00, 21:30 (SAT · SUN) 05:30, 09:30, 13:00, 17:00, 21:30	Travel Time: 3 hours

Route 2

Incheon Airport ↔ (Gimpo Airport) ↔ (Munmak) ↔ **Wonju** (Cross-Country Bus Termial)
 ←(transfer)→ **Wonju** (Bus Stop) ↔ **Phoenix Park**

● Cross-country Bus Stop for Wonju



● Cross-country Bus for Wonju



Incheon Airport ↔ (via Gimpo Airport) ↔ (via Munmak) ↔ Wonju (Bus Terminal)							
Incheon → Wonju				Wonju → Incheon			
Incheon	(Gimpo)	(Munmak)	Wonju	Wonju	(Munmak)	(Gimpo)	Incheon
Departure Bus Stop : 8A Travel Time : 2h 40m It may take more time by traffic jam according to the bad weather conditions etc. Departure Time Interval : Every 1 hour But there is no bus at the time marked by red font with a cancellation line on the left side. One-way fare : 12,100won (Gimpo Wonju : 9,600won)							
09:10	09:40	11:35	11:50	06:00	06:15	08:10	08:40
10:10	10:40	12:35	12:50	07:00	07:15	09:10	09:40
11:10	11:40	13:35	13:50	08:00	08:15	10:10	10:40
12:10	12:40	14:35	14:50	09:00	09:15	11:10	11:40
13:10	13:40	15:35	15:50	10:00	10:15	12:10	12:40
14:10	14:40	16:35	16:50	11:00	11:15	13:10	13:40
15:10	15:40	17:35	17:50	12:00	12:15	14:10	14:40
16:10	16:40	18:35	18:50	13:00	13:15	15:10	15:40
17:10	17:40	19:35	19:50	14:00	14:15	16:10	16:40
18:10	18:40	20:35	20:50	15:00	15:15	17:10	17:40
19:10	19:40	21:35	21:50	16:00	16:15	18:10	18:40
20:10	20:40	22:35	22:50	17:00	17:15	19:10	19:40
21:10	21:40	23:35	23:50	18:00	18:15	20:10	20:40

TRANSPORTATIONS (by Bus)

- Bus arrived from Incheon at Wonju Terminal



- Front-side of Wonju Cross-country Bus Terminal



- Map between Wonju Cross-country Bus Terminal and Bus Stop for Phoenix Park around underpass

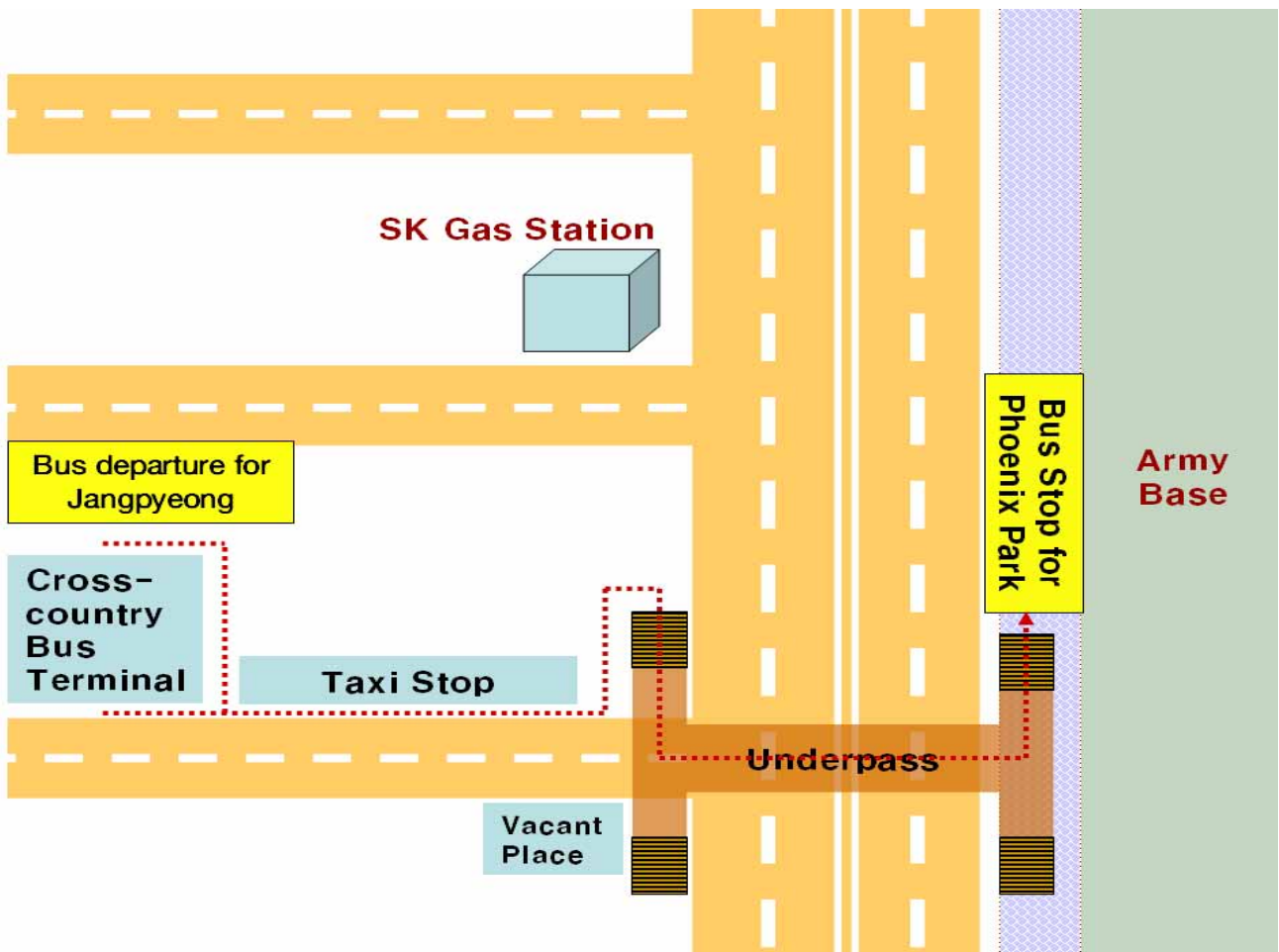

TRANSPORTATIONS (by Bus)

(TRANSFER) : It takes about 3 minutes on foot between **Wonju Cross-country Bus Terminal** and **Bus Stop for Phoenix Park**.

● Underpass Entrance from Bus Terminal

● Underground Crosswalk

● Bus Stop for Phoenix Park

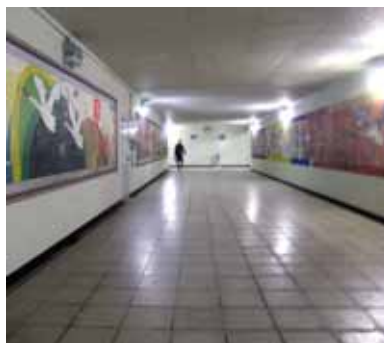

Wonju (Bus Terminal) ↔ Phoenix Park			
	Wonju Phoenix Park	Phoenix Park Wonju	Remark
~ Feb.19	07:43	(05:30 : SAT·SUN)	Travel Time : 45 minutes Free Shuttle : no charge Frequently, departure time of the free shuttle bus for Phoenix Park might be earlier or later than 10 minutes because of the several unavoidable reasons. Thus, you must be at the bus stop at least 15 minutes earlier than the departure time as shown on the left side of this table. This bus stop is shared by many kinds of buses, and it is not dedicated to the free shuttle bus for Phoenix Park.
	09:43	09:30	
	10:43	12:30	
	13:43	14:30	
	15:43	16:30	
	17:43	18:30	
	19:43	20:30	
	20:43	22:30	
Feb.20 ~	07:43	09:30	In order to get on the bus exactly, it might be useful to show the following Korean Sentence. <div style="text-align: right;">(Phoenix Park) 가</div> <div style="text-align: right;">.</div> (Please help me to take the free shuttle bus for Phoenix Park.)
	10:43	13:30	
	14:43	16:30	
	19:43	18:30	
		22:30	



TRANSPORTATIONS (by Bus)

Route 3

Incheon Airport ↔ (Gimpo Airport) ↔ (Munmak) ↔ **Wonju** (transfer at Cross-Country Bus Terminal)
 ↔ **Jangpyeong** (transfer at Bus Stop for **Phoenix park**) ↔ **Phoenix park**

● Bus Ticket Counter for Jangpyeong (No. 9)



● Cross-country Bus for Jangpyeong (Below No. 4)



Wonju (Bus Terminal) ↔ Jangpyeong (Bus Terminal)

Wonju Jangpyeong	Jangpyeong Wonju	Remark
07:00	07:40	Travel Time : 45 minutes One-way fare : 3,600 won
07:50	08:50	
08:00	09:40	Because Jangpyeong is not the final bus stop, you'd better request the bus driver to let you get off at Jangpyeong Bus Terminal.
09:15	10:50	
09:50	11:10	In this case, you can ask for help by showing the following Korean sentence.
10:05	12:20	
11:00	13:20	(Jangpyeong)
11:15	13:45	
11:35	14:35	(Please let me get off at Jangpyeong Bus Terminal.)
11:50	14:50	
12:10	15:45	
12:25	16:00	
13:20	16:20	
13:40	17:00	
14:30	17:30	
15:05	18:10	
15:25	18:30	
15:35	18:45	
16:30	19:45	
16:50	20:30	
17:20		
17:35		
18:00		
18:05		
18:35		
18:55		
19:05		
19:40		

● Jangpyeong Bus Terminal Building



● Front yard of Jangpyeong Bus Terminal



(TRANSFER) : Free Shuttle for Phoenix Park departs at the telephone booth of Jangpyeong Bus Terminal. (You can find the bus stop easily and it takes less than a minute on foot.)

● Free Shuttle Bus Stop for Phoenix Park



● Free Shuttle Bus for Phoenix Park





TRANSPORTATIONS (by Bus)

Jangpyeong (Bus Terminal) ↔ Phoenix Park		
Jangpyeong Phoenix Park	Phoenix Park Jangpyeong	Remark
09:00	08:30	Travel Time : 20 minutes Free Shuttle : no charge
10:00	09:30	
11:00	10:30	
12:00	11:30	
13:00	12:30	
14:00	13:30	
15:00	14:30	
16:00	15:30	
17:00	16:30	
18:00	17:30	
19:00	18:30	
20:00	19:30	
21:00	20:30	
	21:30	There is no bus for Jangpyeong at 21:30.
	22:30	

● Phoenix Park Hotel (ICACT 2006 Conference Site)



● Phoenix Park



For more detailed information, please look at the website as follows

<http://phoenixpark.co.kr/english/transport.html>

<http://icact.org/common/transportation.asp>

<http://www.airport.or.kr/Eng/home.jsp>

<http://www.kcat.co.kr/index.html?v=eng>

1. VOLTAGE

In Korea, 220 Volt and 60 Herz outlets with Type C or Type F are most commonly used now.



2. WEATHER

Korea has four distinct seasons - spring, summer, fall and winter. Skiing season starts from late November and lasts to early March. Especially the inland area of Gangwon province is most snowy, windy and coldest in winter season. Therefore you must prepare and wear the winter clothes for the cold weather. For your correct weather information, please refer to the following URL of Korea Weather Forecasting Authority.

http://www.kma.go.kr/eng/wis/wis01_wf02.jsp?area=11D10301&name=Chuncheon

3. 1330 KOREA TRAVEL PHONE

For English assistance or travel Information, just dial **1330**, and a bilingual operator will offer you detailed tourism information.

http://english.tour2korea.com/01TripPlanner/TouristInfo/1330.asp?kosm=m1_7&konum=2

4. Other Useful Informations about Korea

Please refer to the following URL of Incheon International Airport and Korea Tourism Organization.

<http://www.airport.or.kr/Eng/travel/travel.jsp>

<http://www.tour2korea.com/>

<http://www.happy700.or.kr/>

<http://en.yes-pc.net/>

	
1) Name	SAMSUNG SDS Co., Ltd.
2) Address	Il-Ok Tower, 707-19, Yeoksam-2 Dong, Gangnam-Gu, Seoul, Korea, 135-918
3) Web	http:// www.samsungsd.net
4) Introduction	- Global Business Intergrator/ Consulting service, SI, E-biz

	
1) Name	LG CNS Co.,Ltd
2) Address	Prime Tower #10-1, Hoehyun-dong, 2-ga, jung-gu, Seoul, Korea
3) Web	http://www.lgcns.com
4) Introduction	- Global Business Intergrator/ Consulting service, SI, E-biz

	
1) Name	SK NETWORKS Co., Ltd.
2) Address	199-15, Euljiro-2Ga, Jung-Gu, Seoul, Korea 100-192, KOREA
3) Web	http:// www.sknetworks.com
4) Introduction	- Information and Communications, Trading, Energy Sales



MEMO

Supported by

National Computerization Agency, Electronics and Telecommunications Research Institute, IEEE Communications Society, IEEE Daejeon Section, Open Standards and Internet Association, Korean Institute of Communication Sciences, IEEE Communications Society, SAMSUNG SDS Co., Ltd., LG CNS Co., Ltd., SK Networks Co., Ltd.

<http://www.icact.org/>